

NOTICE!!

These documents have been scanned!

Do not place un-scanned documents beneath this notice!

Do not remove this notice from this file!

GPO Jacket No. 560-102
Print Order 61540
Rise Business Services, LLC
Job=AZ15 6/26/2019



Box Number= AZ15134



Claim Begin-End: AMC356003-AMC356005

1 Initial Receipt



AZ15134-1

AMC356454-AMC363464

United States Department of the Interior
Bureau of Land Management
 BUSINESS & SUPPORT SVCS DIV
 222 N CENTRAL AVE
 PHOENIX, AZ 85004 -2203
 Phone: (602) 417-9200

Receipt	
No:	446635

Transaction #: 469342	
Date of Transaction: 02/19/2002	
CUSTOMER:	MARTIN J MCKENNA RED HILLS MINING, LLC 4101 E. TAMAYA STREET PHOENIX, AZ 85044
ENTERED IN COMPUTER <i>RE 2/25/2002</i>	

LINE #	QTY	DESCRIPTION	REMARKS	UNIT PRICE	TOTAL
1	3.00	IAC PRODUCTS / COPIES / CASEFILE/DOCUMENT COPIES / COPIES (B/W UP TO 11X17)-\$.13/P		\$0.13	\$0.39
2	3.00	LOCATABLE MINERALS / MINING CLAIMS-NEW, UNADJUDI, ONE OR MORE AUTH NO'S / NEW MINING CLAIM SVC CHG \$10 (1930) CASES: AMC356003/\$10.00, AMC356004/\$10.00, AMC356005/\$10.00		- n/a -	\$30.00
3	3.00	LOCATABLE MINERALS / MINING CLAIMS-NEW, UNADJUDI, ONE OR MORE AUTH NO'S / NEW MINING CLM MAINT FEE \$100(1993) CASES: AMC356003/\$100.00, AMC356004/\$100.00, AMC356005/\$100.00		- n/a -	\$300.00
4	3.00	LOCATABLE MINERALS / MINING CLAIMS-NEW, UNADJUDI, ONE OR MORE AUTH NO'S / NEW MINING CLAIM LOCATION FEE \$25(1993) CASES: AMC356003/\$25.00, AMC356004/\$25.00, AMC356005/\$25.00		- n/a -	\$75.00
TOTAL:					\$405.39

PAYMENT INFORMATION			
1	AMOUNT:	\$405.39	POSTMARKED: N/A
	TYPE:	CHECK	RECEIVED: 02/19/2002
	CHECK NO:	1012	
	NAME:	RED HILLS MINING, LLC MCKENNA, MARTIN J 4101 E. TAMAYA STREET PHOENIX AZ 85044	

REMARKS

This receipt was generated by the automated BLM Collections and Billings System and is a paper representation of a portion of the official electronic record contained therein.

NOTICE!!

These documents have been scanned!

Do not place un-scanned documents beneath this notice!

Do not remove this notice from this file!

GPO Jacket No. 560-102
Print Order 61540
Rise Business Services, LLC
Job=AZ15 6/26/2019



Box Number= AZ15134



Claim Begin-End: AMC356003-AMC356005

2 Correspondence



AZ15134-1

AMC356454-AMC363464

**NO
DOCUMENTS
FOUND**

NO DOCUMENTS FOUND
NO DOCUMENTS FOUND

NOTICE!!

These documents have been scanned!

Do not place un-scanned documents beneath this notice!

Do not remove this notice from this file!

GPO Jacket No. 560-102
Print Order 61540
Rise Business Services, LLC
Job=AZ15 6/26/2019



Box Number= AZ15134



Claim Begin-End: AMC356003-AMC356005

3 Transfers



AZ15134-1

AMC356454-AMC363464

**NO
DOCUMENTS
FOUND**

NO DOCUMENTS FOUND
NO DOCUMENTS FOUND

NOTICE!!

These documents have been scanned!

Do not place un-scanned documents beneath this notice!

Do not remove this notice from this file!

GPO Jacket No. 560-102
Print Order 61540
Rise Business Services, LLC
Job=AZ15 6/26/2019



Box Number= AZ15134



Claim Begin-End: AMC356003-AMC356005

4 Annual Filings



AZ15134-1

AMC356454-AMC363464

356003
 356059
 356123
 336106
 376428
 401831

MAINTENANCE FEE PAYMENT

Claimant Name: Clarence Heister
 Address: PO BOX 937
 City: Globe State: Az Zip: 85502
 Telephone: 602-722-0861
 E-mail address: _____
 Signature: Clarence B Heister

RECEIVED
 ARIZONA STATE OFFICE
 2018 AUG 27 P 1:08
 PHOENIX, ARIZONA
 BLM
 Date
 Stamp

Check here if this is a change of address.

LINE NO.	AMC NUMBER	CLAIM/SITE NAME	COUNTY RECORDER DATA (If available)	TWP	RNG	SEC
1	356003	BLUEROCK 20				
2	004	21				
3	005	22				
4	059	23				
5	060	24				
6	061	25				
7	062	26				
8	063	27				
9	064	28				
10	065	29				

List additional claims on Form MCF114.

Bureau of Land Management
 Arizona State Office
www.blm.gov/az/

No. of Claims*: 49 x \$155 = \$7595.
 Check No: 1023 Init. ERC
 Receipt No.: 4246087
 For BLM Use Only

* \$155 per lode mining claim, mill site, or tunnel site; and \$155 for each 20 acres or portion thereof for each placer mining claim.

Form: MCF112
 Revised July 2014

This form is available from the Arizona Geological Survey and may be reproduced.

ENTERED AUG 28 2018
 AC 782 PB

SUPPLEMENTAL ATTACHMENT

May be used with the following forms for listing additional mining claims:

Check One.

- Affidavit of Performance of Annual Work
- Maintenance Fee Payment
- Notice of Intent to Hold Mining Claims
- Notice of Non-Liability for Labor and Materials Furnished
- Quit claim Deed

RECEIVED
BLM AZ STATE OFFICE
PHOENIX, ARIZONA
2018 AUG 27 P 1:08
BLM
Date
Stamp

LINE NO.	AMC NUMBER	CLAIM/SITE NAME	COUNTY RECORDER DATA (If available)	TWP	RANGE	SEC
11	336106	Bluerock 1				
12	107	2				
13	108	3				
14	109	4				
15	110	5				
16	114	9				
17	116	11				
18	121	16				
19	356066	Bluerock 30				
20	067	31				
21	068	32				
22	069	33				
23	070	34				
24	071	35				
25	072	36				
26	073	37				
27	074	38				
28	075	39				
29	356123	40				

ENTERED AUG 28 2018

AC 782 PB

Form MCF114
Revised July 2014

SUPPLEMENTAL ATTACHMENT

May be used with the following forms for listing additional mining claims:

Check One.

- Affidavit of Performance of Annual Work
- Maintenance Fee Payment
- Notice of Intent to Hold Mining Claims
- Notice of Non-Liability for Labor and Materials Furnished
- Quit claim Deed

RECEIVED
BLM AZ STATE OFFICE
2018 AUG 21 P 1:08
PHOENIX, ARIZONA

BLM
Date
Stamp

LINE NO.	AMC NUMBER	CLAIM/SITE NAME	COUNTY RECORDER DATA (If available)	TWP	RNG	SEC
30	356124	BLUEROCK				
31	125					
32	126					
33	127					
36	128					
35	129					
36	130					
37	131					
38	132					
39	133					
40	134					
41	135					
42	136					
43	137					
44	376428					
45	429					
46	430					
47	431					
48	432					

ENTERED AUG 28 2018

AC 782 PB

Form MCF114
Revised July 2014

This form is available from the Arizona Geological Survey and may be reproduced.

SUPPLEMENTAL ATTACHMENT

May be used with the following forms for listing additional mining claims:

Check One.

- Affidavit of Performance of Annual Work
- Maintenance Fee Payment
- Notice of Intent to Hold Mining Claims
- Notice of Non-Liability for Labor and Materials Furnished
- Quit claim Deed

RECEIVED
 PHOENIX, ARIZONA
 2018 AUG 27 P 1:08
 BLM Date Stamp

LINE NO.	AMC NUMBER	CLAIM/SITE NAME	COUNTY RECORDER DATA (If available)	TWP	RNG	SEC
49	401831	BLUEROCK 14				
		Ac 782				

ENTERED AUG 28 2018

Form MCF114
 Revised July 2014

PB

United States Department of the Interior
Bureau of Land Management
 DIV OF LANDS, MINRLS & ENERGY
 ONE N CENTRAL AVE
 PHOENIX, AZ 85004 -4427
 Phone: 602-417-9200

Receipt

No: 4246087

Transaction #: 4361538	
Date of Transaction: 08/27/2018	
CUSTOMER:	
CLARENCE HEISLER PO BOX 937 GLOBE, AZ 85502-0937 US	

AC 782
ENTERED AUG 28 2018
PS

LINE #	QTY	DESCRIPTION	REMARKS	UNIT PRICE	TOTAL
1	1.00	LOCATABLE MINERALS / MINING CLAIMS- NOT NEW-UNADJUD, ONE AUTH NO. ONLY / MINING CLAIM MONEY RECEIVED CASES: AMC356003/\$7595.00	2019 MAINT (49)	- n/a -	7595.00
TOTAL:					\$7,595.00

PAYMENT INFORMATION			
1	AMOUNT:	7595.00	POSTMARKED: N/A
	TYPE:	CHECK	RECEIVED: 08/27/2018
	CHECK NO:	1023	
	NAME:	RED HILLS MINING LLC 32526 E HAWKVIEW RD FLORENCE AZ 85232 US	

REMARKS

This receipt was generated by the automated BLM Collections and Billing System and is a paper representation of a portion of the official electronic record contained therein.

3

356003

356059

356123

336106

MAINTENANCE FEE PAYMENT

Claimant Name: Clarence Heister

Address: P.O. Box 937

City: Globe State: Az Zip: 85502

Telephone: 602-722-0861

E-mail address: _____

Signature: Clarence B Heister

Check here if this is a change of address.

376428 401831	PHOENIX, ARIZONA	2017 AUG 30 P 12:30	RECEIVED BLM AT STATE OFFICE
BLM Date Stamp			

LINE NO.	AMC NUMBER	CLAIM/SITE NAME	COUNTY RECORDER DATA (if available)	TWP	RNG	SEC
1	356003	Bluerock 20				
2	004	21				
3	005	22				
4	059	23				
5	060	24				
6	061	25				
7	062	26				
8	063	27				
9	064	28				
10	065	29				

List additional claims on Form MCF114.

Bureau of Land Management
Arizona State Office
www.blm.gov/az/

No. of Claims*: <u>49</u> x \$155 = <u>7595.00</u>
Check No: <u>1019</u> Init. <u>ES</u>
Receipt No.: <u>3966015</u>
For BLM Use Only

* \$155 per lode mining claim, mill site, or tunnel site; and \$155 for each 20 acres or portion thereof for each placer mining claim.

Form: MCF112
Revised July 2014

This form is available from the Arizona Geological Survey and may be reproduced.

ENTERED
AUG 31 2017
BY: RMM

May be used with the following forms for listing additional mining claims:

Check One.

- Affidavit of Performance of Annual Work
- Maintenance Fee Payment
- Notice of Intent to Hold Mining Claims
- Notice of Non-Liability for Labor and Materials Furnished
- Quit claim Deed

BLM
Date
Stamp

PHOENIX, ARIZONA

2011 AUG 30

12:36

RECEIVED
STATE OFFICE

LINE NO.	AMC NUMBER	CLAIM/SITE NAME	COUNTY RECORDER DATA (If available)	TWP	RNG	SEC
11	336106	Bluerock 1				
12	107	2				
13	108	3				
14	109	4				
15	110	5				
16	114	9				
17	116	11				
18	121	16				
19	356066	Bluerock 30				
20	067	31				
21	068	32				
22	069	33				
23	070	34				
24	071	35				
25	072	36				
26	073	37				
27	074	38				
28	075	39				
29	356123	40				

Form MCF114
Revised July 2014

This form is available from the Arizona Geological Survey and may be reproduced.

May be used with the following forms for listing additional mining claims:

Check One.

- Affidavit of Performance of Annual Work
- Maintenance Fee Payment
- Notice of Intent to Hold Mining Claims
- Notice of Non-Liability for Labor and Materials Furnished
- Quit claim Deed

BLM
Date
Stamp

RECEIVED
STATE OF ARIZONA
2011 AUG 30 P 12:36
PHOENIX, ARIZONA

LINE NO.	AMC NUMBER	CLAIM/SITE NAME	COUNTY RECORDER DATA (If available)	TWP	RNG	SECTION
30	356124	BLUEROCK				
31	125					
32	126					
33	127					
36	128					
35	129					
36	130					
37	131					
38	132					
39	133					
40	134					
41	135					
42	136					
43	137					
44	376428					
45	429					
46	430					
47	431					
48	432					

Form MCF114
Revised July 2014

This form is available from the Arizona Geological Survey and may be reproduced.

May be used with the following forms for listing additional mining claims:

Check One.

- Affidavit of Performance of Annual Work
- Maintenance Fee Payment
- Notice of Intent to Hold Mining Claims
- Notice of Non-Liability for Labor and Materials Furnished
- Quit claim Deed

BLM
Date
Stamp

RECEIVED
MAY STAFF OFFICE
2011 AUG 30 12:36
PHOENIX, ARIZONA

LINE NO.	AMC NUMBER	CLAIM/SITE NAME	COUNTY RECORDER DATA (If available)	TWP	RNG	SECTION
49	401831	Bluestone 14				

Form MCF114
Revised July 2014

This form is available from the Arizona Geological Survey and may be reproduced.

United States Department of the Interior
Bureau of Land Management
 DIV OF LANDS, MINRLS & ENERGY
 ONE N CENTRAL AVE
 PHOENIX, AZ 85004 -4427
 Phone: 602-417-9200

Receipt

No: 3966015

Transaction #: 4075895	
Date of Transaction: 08/30/2017	
CUSTOMER:	
CLARENCE HEISLER PO BOX 937 GLOBE, AZ 85502-0937 US	

LINE #	QTY	DESCRIPTION	REMARKS	UNIT PRICE	TOTAL
1	1.00	LOCATABLE MINERALS / MINING CLAIMS- NOT NEW-UNADJUD, ONE AUTH NO. ONLY / MINING CLAIM MONEY RECEIVED CASES: AMC356003/\$7595.00	2018 MAINT (49)	- n/a -	7595.00
TOTAL:					\$7,595.00

PAYMENT INFORMATION			
1	AMOUNT:	7595.00	POSTMARKED: N/A
	TYPE:	CHECK	RECEIVED: 08/30/2017
	CHECK NO:	1019	
	NAME:	RED HILLS MINING LLC 32526 E HAWKVIEW RD FLORENCE AZ 85232 US	

REMARKS

This receipt was generated by the automated BLM Collections and Billing System and is a paper representation of a portion of the official electronic record contained therein.

356003
 356059
 336106
 356123
 376428
 401831

MAINTENANCE FEE PAYMENT

Claimant Name: Clarence Heister
 Address: P.O. BOX 937
 City: Globe State: Az Zip: 85502
 Telephone: 602-722-0861
 E-mail address: _____
 Signature: Clarence B Heister

RECEIVED
 BLM AZ STATE OFFICE
 2016 AUG 29 P 1:18
 PHOENIX, ARIZONA
 BLM
 Date
 Stamp

Check here if this is a change of address.

LINE NO.	AMC NUMBER	CLAIM/SITE NAME	COUNTY RECORDER DATA (If available)	TWP	RNG	SEC
1	356003	BLUEROCK 20				
2	004	21				
3	005	22				
4	059	23				
5	060	24				
6	061	25				
7	062	26				
8	063	27				
9	064	28				
10	065	29				

List additional claims on Form MCF114.

Bureau of Land Management
 Arizona State Office
www.blm.gov/az/

No. of Claims*: 49 x \$155 = 7595
 Check No: 1009 Init. PETZ
 Receipt No.: 3645215
 For BLM Use Only

* \$155 per lode mining claim, mill site, or tunnel site; and \$155 for each 20 acres or portion thereof for each placer mining claim.

Form: MCF112
 Revised July 2014

This form is available from the Arizona Geological Survey and may be reproduced.

ENTERED
 AUG 30 2016
 BY: RE

SUPPLEMENTAL ATTACHMENT

May be used with the following forms for listing additional mining claims:

Check One.

- Affidavit of Performance of Annual Work
- Maintenance Fee Payment
- Notice of Intent to Hold Mining Claims
- Notice of Non-Liability for Labor and Materials Furnished
- Quit claim Deed

BLM Date Stamp	RECEIVED BLM AZ STATE OFFICE 2016 AUG 29 P 1:18 PHOENIX, ARIZONA
----------------------	---

LINE NO.	AMC NUMBER	CLAIM/SITE NAME	COUNTY RECORDER DATA (If available)	TWP	RNG	SEC
11	336106	BLUEROCK 1				
12	107	2				
13	108	3				
14	109	4				
15	110	5				
16	114	9				
17	116	11				
18	121	16				
19	356066	BLUEROCK 30				
20	067	31				
21	068	32				
22	069	33				
23	070	34				
24	071	35				
25	072	36				
26	073	37				
27	074	38				
28	075	39				
29	356123	40				

Form MCF114
Revised July 2014

This form is available from the Arizona Geological Survey and may be reproduced.

SUPPLEMENTAL ATTACHMENT

May be used with the following forms for listing additional mining claims:

Check One.

- Affidavit of Performance of Annual Work
- Maintenance Fee Payment
- Notice of Intent to Hold Mining Claims
- Notice of Non-Liability for Labor and Materials Furnished
- Quit claim Deed

RECEIVED
BLM AZ STATE OFFICE
2016 AUG 29 P 1:18
PHOENIX, ARIZONA

BLM
Date
Stamp

LINE NO.	AMC NUMBER	CLAIM/SITE NAME	COUNTY RECORDER DATA (If available)	TWP	RNG	SEC
30	356124	BLUEROCK				
31	125					
32	126					
33	127					
36	128					
35	129					
36	130					
37	131					
38	132					
39	133					
40	134					
41	135					
42	136					
43	137					
44	376428					
45	429					
46	430					
47	431					
48	432					

401831 Bluerock 14

Form MCF114
Revised July 2014

SUPPLEMENTAL ATTACHMENT

May be used with the following forms for listing additional mining claims:

Check One.

- Affidavit of Performance of Annual Work
- Maintenance Fee Payment
- Notice of Intent to Hold Mining Claims
- Notice of Non-Liability for Labor and Materials Furnished
- Quit claim Deed

BLM Date Stamp	RECEIVED BLM AZ STATE OFFICE 2016 AUG 29 P 1:18 PHOENIX, ARIZONA
----------------------	---

LINE NO.	AMC NUMBER	CLAIM/SITE NAME	COUNTY RECORDER DATA (If available)	TWP	RNG	SEC
49	401831	Blue Rock 14				

United States Department of the Interior
Bureau of Land Management
 DIV OF LANDS, MINRLS & ENERGY
 ONE N CENTRAL AVE
 PHOENIX, AZ 85004 -4427
 Phone: 602-417-9200

Receipt

No: 3645215

Transaction #: 3749196	
Date of Transaction: 08/29/2016	
CUSTOMER:	
CLARENCE HEISLER PO BOX 937 GLOBE, AZ 85502-0937 US	

LINE #	QTY	DESCRIPTION	REMARKS	UNIT PRICE	TOTAL
1	1.00	LOCATABLE MINERALS / MINING CLAIMS- NOT NEW-UNADJUD, ONE AUTH NO. ONLY / MINING CLAIM MONEY RECEIVED CASES: AMC356003/\$7595.00	2017 MAINT/49	- n/a -	7595.00
TOTAL:					\$7,595.00

PAYMENT INFORMATION			
1	AMOUNT:	7595.00	POSTMARKED: N/A
	TYPE:	CHECK	RECEIVED: 08/29/2016
	CHECK NO:	1009	
	NAME:	HEISLER, CLARENCE PO BOX 937 GLOBE AZ 85502-0937 US	

REMARKS

This receipt was generated by the automated BLM Collections and Billing System and is a paper representation of a portion of the official electronic record contained therein.

356003
 356059
 336106
 356123
 376428
 401831

MAINTENANCE FEE PAYMENT

Claimant Name: Clarence Heister
 Address: P.O. Box 937
 City: Globe State: Az Zip: 85502
 Telephone: 602-722-0861
 E-mail address: _____
 Signature: Clarence B Heister

BLM Date Stamp	PHOENIX, ARIZONA	2015 AUG 31 P 12: 53	RECEIVED BLM AZ STATE OFFICE
----------------------	------------------	----------------------	---------------------------------

Check here if this is a change of address.

LINE NO.	AMC NUMBER	CLAIM/SITE NAME	COUNTY RECORDER DATA (If available)	TWP	RNG	SEC
1	356003	BLUEROCK 20				
2	004	21				
3	005	22				
4	059	23				
5	060	24				
6	061	25				
7	062	26				
8	063	27				
9	064	28				
10	065	29				

List additional claims on Form MCF114.

Bureau of Land Management
Arizona State Office
www.blm.gov/az/

No. of Claims*: <u>49</u> x \$155 = <u>7,595</u>
Check No: <u>1005</u> Init. <u>YML</u>
Receipt No.: <u>3381617</u>
For BLM Use Only

* \$155 per lode mining claim, mill site, or tunnel site; and \$155 for each 20 acres or portion thereof for each placer mining claim.

Form: MCF112
 Revised July 2014

This form is available from the **Arizona Geological Survey** and may be reproduced.

SEP 01 2015
 R. Am

SUPPLEMENTAL ATTACHMENT

May be used with the following forms for listing additional mining claims:

Check One.

- Affidavit of Performance of Annual Work
- Maintenance Fee Payment
- Notice of Intent to Hold Mining Claims
- Notice of Non-Liability for Labor and Materials Furnished
- Quit claim Deed

RECEIVED
BLM AZ STATE OFFICE
2015 AUG 31 P 12:53
PHOENIX, ARIZONA
BLM
Date
Stamp

LINE NO.	AMC NUMBER	CLAIM/SITE NAME	COUNTY RECORDER DATA (If available)	TWP	RNG	SEC
11	336106	Bluerock 1				
12	107	2				
13	108	3				
14	109	4				
15	110	5				
16	114	9				
17	116	11				
18	121	16				
19	336066	Bluerock 30				
20	067	31				
21	068	32				
22	069	33				
23	070	34				
24	071	35				
25	072	36				
26	073	37				
27	074	38				
28	075	39				
29	336123	40				

Form MCF114
Revised July 2014

This form is available from the Arizona Geological Survey and may be reproduced.

SUPPLEMENTAL ATTACHMENT

May be used with the following forms for listing additional mining claims:

Check One.

- Affidavit of Performance of Annual Work
- Maintenance Fee Payment
- Notice of Intent to Hold Mining Claims
- Notice of Non-Liability for Labor and Materials Furnished
- Quit claim Deed

RECEIVED
 BLM AZ STATE OFFICE
 2015 AUG 31 P 12:53
 PHOENIX, ARIZONA
 BLM
 Date
 Stamp

LINE NO.	AMC NUMBER	CLAIM/SITE NAME	COUNTY RECORDER DATA (If available)	TWP	RNG	SEC
30	356124 ⁷	BLUEROCK				
31	125					
32	126					
33	127					
36	128					
35	129					
36	130					
37	131					
38	132					
39	133					
40	134					
41	135					
42	136					
43	137					
44	376428 ⁷					
45	429					
46	430					
47	431					
48	432					

Form MCF114
 Revised July 2014

This form is available from the Arizona Geological Survey and may be reproduced.

SUPPLEMENTAL ATTACHMENT

May be used with the following forms for listing additional mining claims:

Check One.

- Affidavit of Performance of Annual Work
- Maintenance Fee Payment
- Notice of Intent to Hold Mining Claims
- Notice of Non-Liability for Labor and Materials Furnished
- Quit claim Deed

RECEIVED
BLM AZ STATE OFFICE

2015 AUG 31 P 12: 53

PHOENIX, ARIZONA

BLM
Date
Stamp

LINE NO.	AMC NUMBER	CLAIM/SITE NAME	COUNTY RECORDER DATA (If available)	TWP	RNG	SEC
49	401831	Bluerock 14				

Form MCF114
Revised July 2014

United States Department of the Interior
Bureau of Land Management
 LANDS/RECREATION & PLANNING
 ONE N CENTRAL AVE
 PHOENIX, AZ 85004 -2203
 Phone: 602-417-9200

Receipt

No: 3381617

Transaction #: 3479910	
Date of Transaction: 08/31/2015	
CUSTOMER:	
CLARENCE HEISLER PO BOX 937 GLOBE, AZ 85502-0937 US	

LINE #	QTY	DESCRIPTION	REMARKS	UNIT PRICE	TOTAL
1	1.00	LOCATABLE MINERALS / MINING CLAIMS- NOT NEW-UNADJUD, ONE AUTH NO. ONLY / MINING CLAIM MONEY RECEIVED CASES: AMC356003/\$7595.00	MAINT 2016/49	- n/a -	7595.00
TOTAL:					\$7,595.00

PAYMENT INFORMATION			
1	AMOUNT:	7595.00	POSTMARKED: N/A
	TYPE:	CHECK	RECEIVED: 08/31/2015
	CHECK NO:	1005	
	NAME:	HEISLER, CLARENCE 32526 E HAWKVIEW RD FLORENCE AZ 85232 US	

REMARKS

This receipt was generated by the automated BLM Collections and Billing System and is a paper representation of a portion of the official electronic record contained therein.

401831 336106
 356003
 356059
 356123
 376428

MAINTENANCE FEE PAYMENT

Claimant Name: CLARENCE HEISLER
 Address: PO BOX 937
 City: GLUCON State: AZ Zip: 85502
 Telephone: 602-722-0861
 E-mail address: _____
 Signature: Clarence Heisler

RECEIVED
 AZ STATE OFFICE
 2014 AUG 29 P 12:21
 PHOENIX, ARIZONA
 BLM
 Date
 Stamp

Check here if this is a change of address.

LINE NO.	AMC NUMBER	CLAIM/SITE NAME	COUNTY RECORDER DATA (If available)	TWP	RNG	SEC
1	356003	Bluerock 20				
2	004	21				
3	005	22				
4	059	23				
5	060	24				
6	061	25				
7	062	26				
8	063	27				
9	064	28				
10	065	29				

List additional claims on Form MCF114.

Bureau of Land Management
 Arizona State Office
www.blm.gov/az/

INTEREST
 SEP 02 2014
 13

No. of Claims*: 49 x \$155 = 7595
 Check No: 1036888798 Init. YML
 Receipt No.: 3117364
 For BLM Use Only

* \$155 per lode mining claim, mill site, or tunnel site; and \$155 for each 20 acres or portion thereof for each placer mining claim.

Form: MCF112
 Revised July 2014

SUPPLEMENTAL ATTACHMENT

May be used with the following forms for listing additional mining claims:

Check One.

- Affidavit of Performance of Annual Work
- Maintenance Fee Payment
- Notice of Intent to Hold Mining Claims
- Notice of Non-Liability for Labor and Materials Furnished

RECEIVED
 M AZ STATE OFFICE
 2014 AUG 29 P 12: 21
 PHOENIX, ARIZONA
 BLM
 Date
 Stamp

LINE NO.	AMC NUMBER	CLAIM/SITE NAME	COUNTY RECORDER DATA (if available)	TWP	RNG	SEC
11	336106	Bluerock 1				
12	107	2				
13	108	3				
14	109	4				
15	110	5				
16	114	9				
17	116	11				
18	121	16				
19	356066	Bluerock 30				
20	067	31				
21	068	32				
22	069	33				
23	070	34				
24	071	35				
25	072	36				
26	073	37				
27	074	38				
28	075	39				
29	356123	40				

Form MCF114
 Revised June 2005

SUPPLEMENTAL ATTACHMENT

May be used with the following forms for listing additional mining claims:

Check One.

- Affidavit of Performance of Annual Work
- Maintenance Fee Payment
- Notice of Intent to Hold Mining Claims
- Notice of Non-Liability for Labor and Materials Furnished

RECEIVED
 ARIZONA STATE OFFICE
 PHOENIX, ARIZONA
 2014 AUG 29 P 12:22
 BLM
 Date
 Stamp

LINE NO.	AMC NUMBER	CLAIM/SITE NAME	COUNTY RECORDER DATA (If available)	TWP	RNG	SEC
30	356124	Bluerod				
31	129					
32	126					
33	127					
34	128					
35	129					
36	130					
37	131					
38	132					
39	133					
40	134					
41	135					
42	136					
43	137					
44	376428					
45	429					
46	430					
47	431					
48	432					

Form MCF114
 Revised June 2005

SUPPLEMENTAL ATTACHMENT

RECEIVED
M AZ STATE OFFICE
2014 AUG 29 P 12: 22
PHOENIX, ARIZONA

BLM
Date
Stamp

May be used with the following forms for listing
additional mining claims:

Check One.

- Affidavit of Performance of Annual Work
- Maintenance Fee Payment
- Notice of Intent to Hold Mining Claims
- Notice of Non-Liability for Labor and Materials Furnished

LINE NO.	AMC NUMBER	CLAIM/SITE NAME	COUNTY RECORDER DATA (If available)	TWP	RNG	SEC
49	461831	BlossRock/4				

Form MCF114
Revised June 2005

This form is available from the Arizona Department of Mines & Mineral Resources and may be reproduced.

United States Department of the Interior
Bureau of Land Management
 LANDS/RECREATION & PLANNING
 ONE N CENTRAL AVE
 PHOENIX, AZ 85004 -2203
 Phone: 602-417-9200

Receipt

No: 3117364

Transaction #: 3209148		ENTERED INTO COMPUTER
Date of Transaction: 08/29/2014		
CUSTOMER:		SEP - 2 2014 JB
CLARENCE HEISLER PO BOX 937 GLOBE, AZ 85502-0937 US		

LINE #	QTY	DESCRIPTION	REMARKS	UNIT PRICE	TOTAL
1	1.00	LOCATABLE MINERALS / MINING CLAIMS- NOT NEW-UNADJUD, ONE AUTH NO. ONLY / MINING CLAIM MONEY RECEIVED CASES: AMC356003/\$7595.00	MAINT 2015/49✓	- n/a -	7595.00
TOTAL:					\$7,595.00

PAYMENT INFORMATION			
1	AMOUNT:	7595.00	POSTMARKED: N/A
	TYPE:	CHECK	RECEIVED: 08/29/2014
	CHECK NO:	1036888798	
	NAME:	HEISLER, CLARENCE PO BOX 937 GLOBE AZ 85502-0937 US	

REMARKS

This receipt was generated by the automated BLM Collections and Billing System and is a paper representation of a portion of the official electronic record contained therein.

356003
~~356110~~
356123
~~356110~~
356059
376428
401831

336106

MAINTENANCE FEE PAYMENT

Claimant Name: CLARENCE HEISLER
Address: PO BOX 937
City: 61039 State: AZ Zip: 85502
Telephone: 602-722-0861
E-mail address:
Signature: Clarence Heisler

Check here if this is a change of address.

RECEIVED
BLM AZ STATE OFFICE
PHOENIX, ARIZONA
2003 AUG 27 P 3:40
BLM
Date
Stamp

LINE NO.	AMC NUMBER	CLAIM/SITE NAME	COUNTY RECORDER DATA (If available)	TWP	RNG	SEC
1	356-003	Bluerock 20				
2	004	21				
3	005	22				
4	059	23				
5	060	24				
6	061	25				
7	062	26				
8	063	27				
9	064	28				
10	065	29				

1060

List additional claims on Form MCF114.

Bureau of Land Management
Arizona State Office
www.blm.gov/az/

No. of Claims: 49 x \$140 = 6860
Check No: 1244 Init. SC
Receipt No.: 2866762
For BLM Use Only

Form: MCF112
Revised July 2009

This form is available from the Arizona Department of Mines and Mineral Resources and may be reproduced.

ENTERED
SEP - 3 2003
BY: RE

SUPPLEMENTAL ATTACHMENT

May be used with the following forms for listing additional mining claims:

Check One.

- Affidavit of Performance of Annual Work
- Maintenance Fee Payment
- Notice of Intent to Hold Mining Claims
- Notice of Non-Liability for Labor and Materials Furnished

BLM
Date
Stamp

BLM RECEIVED
 2013 AUG 27 P 3:40
 PHOENIX, ARIZONA
 OFFICE

LINE NO.	AMC NUMBER	CLAIM/SITE NAME	COUNTY RECORDER DATA (If available)	TWP	RNG	SEC
11	336106 356106	BlossRock	1			
12	336107 107		2			
13	108		3			
14	109		4			
15	110		5			
16	336114 114		9			
17	336116 116		11			
18	336121 121		16			
19	066		30			
20	067		31			
21	068		32			
22	069		33			
23	070		34			
24	071		35			
25	072		36			
26	073		37			
27	074		38			
28	075		39			
29	123		40			

wrong #
336106 to 336110
wrong #
wrong AMC
notified by phone on 10/30/13 RM

19/5c

Form MCF114
Revised June 2005

This form is available from the Arizona Department of Mines & Mineral Resources and may be reproduced.

ENTERED
 11/13/13

SUPPLEMENTAL ATTACHMENT

May be used with the following forms for listing additional mining claims:
Check One.

- Affidavit of Performance of Annual Work
- Maintenance Fee Payment
- Notice of Intent to Hold Mining Claims
- Notice of Non-Liability for Labor and Materials Furnished

BLM
Date
Stamp

RECEIVED
 STATE OFFICE
 2013 AUG 27 P 3:41
 PHOENIX, ARIZONA

LINE NO.	AMC NUMBER	CLAIM/SITE NAME	COUNTY RECORDER DATA (If available)	TWP	RNG	SEC
30	356124					
31	125					
32	126					
33	127					
34	128					
35	129					
36	130					
37	131					
38	132					
39	133					
40	134					
41	135					
42	136					
43	137					
44	378428					
45	429					
46	430					
47	431					
48	432					

19/50

Form MCF114
Revised June 2005

This form is available from the Arizona Department of Mines & Mineral Resources and may be reproduced.

SUPPLEMENTAL ATTACHMENT

May be used with the following forms for listing additional mining claims:

Check One.

- Affidavit of Performance of Annual Work
- Maintenance Fee Payment
- Notice of Intent to Hold Mining Claims
- Notice of Non-Liability for Labor and Materials Furnished

RECEIVED
BLM ARIZONA STATE OFFICE
2013 AUG 27 P 3:41
PHOENIX, ARIZONA
BLM
Date
Stamp

LINE NO.	AMC NUMBER	CLAIM/SITE NAME	COUNTY RECORDER DATA (If available)	TWP	RNG	SEC
49	401831	Blue Rock 4				

Form MCF114
Revised June 2005

This form is available from the Arizona Department of Mines & Mineral Resources and may be reproduced.

1/bc

United States Department of the Interior
Bureau of Land Management
 LANDS/RECREATION & PLANNING
 ONE N CENTRAL AVE
 PHOENIX, AZ 85004 -2203
 Phone: 602-417-9200

Receipt

No: 2866762

Transaction #: 2952691	
Date of Transaction: 08/27/2013	
CUSTOMER:	
CLARENCE HEISLER PO BOX 1169 FLORENCE, AZ 85232-1169 US	

LINE #	QTY	DESCRIPTION	REMARKS	UNIT PRICE	TOTAL
1	1.00	LOCATABLE MINERALS / MINING CLAIMS- NOT NEW-UNADJUD, ONE AUTH NO. ONLY / MINING CLAIM MONEY RECEIVED CASES: AMC356003/\$6860.00	MAINT (49) 2014	- n/a -	6860.00
TOTAL:					\$6,860.00

PAYMENT INFORMATION			
1	AMOUNT:	6860.00	POSTMARKED: N/A
	TYPE:	CHECK	RECEIVED: 08/27/2013
	CHECK NO:	1244	
	NAME:	RED HILLS MINING LLC PO BOX 1169 FLORENCE AZ 85232-1169 US	

REMARKS

This receipt was generated by the automated BLM Collections and Billing System and is a paper representation of a portion of the official electronic record contained therein.

AMC 356003

356059

356123

401831

AMC 336106

376428

MAINTENANCE FEE PAYMENT

Claimant Name: CLARENCE HEWLER

Address: PO BOX 937

City: GLOBE State: AZ Zip: 85502

Telephone: 602-722-0861

E-mail address:

Signature: Clarence Hewler

Check here if this is a change of address.

RECEIVED
BLM AZ STATE OFFICE
2012 AUG 27 A 11:51
PHOENIX, ARIZONA

BLM
Date
Stamp

LINE NO.	AMC NUMBER	CLAIM/SITE NAME	COUNTY RECORDER DATA (If available)	TWP	RNG	SEC
1	356003	Bluelock 20				
2	004	21				
3	005	22				
4	059	23				
5	060	24				
6	061	25				
7	062	26				
8	063	27				
9	064	28				
10	065	29				

List additional claims on Form MCF114.

Bureau of Land Management
Arizona State Office
www.az.blm.gov

No. of Claims: 49 x \$140 6,860
 Check No: 1240 Init. HMC
 Receipt No.: 2641176
 For BLM Use Only

Form: MCF112
Revised July 2005

This form is available from the Arizona Department of Mines and Mineral Resources and may be reproduced.

9/7/2012 TS

ENTERED INTO COMPUTER

SUPPLEMENTAL ATTACHMENT

May be used with the following forms for listing additional mining claims:

Check One.

- Affidavit of Performance of Annual Work
- Maintenance Fee Payment
- Notice of Intent to Hold Mining Claims
- Notice of Non-Liability for Labor and Materials Furnished

RECEIVED
BLM AZ STATE OFFICE
PHOENIX, ARIZONA
2012 AUG 21 A 11:57
BLM
Date
Stamp

LINE NO.	AMC NUMBER	CLAIM/SITE NAME	COUNTY RECORDER DATA (If available)	TWP	RNG	SEC
11	336106	Bluerock 1				
12	107	2				
13	108	3				
14	109	4				
15	110	5				
16	114	9				
17	116	11				
18	121	16				
19	356066	Bluerock 30				
20	067	31				
21	068	32				
22	069	33				
23	070	34				
24	071	35				
25	072	36				
26	073	37				
27	074	38				
28	075	39				
29	356123	40				

Form MCF114
Revised June 2005

SUPPLEMENTAL ATTACHMENT

May be used with the following forms for listing additional mining claims:

Check One.

- Affidavit of Performance of Annual Work
- Maintenance Fee Payment
- Notice of Intent to Hold Mining Claims
- Notice of Non-Liability for Labor and Materials Furnished

RECEIVED
BLM AZ STATE OFFICE
2012 AUG 27 A 11: 57
PHOENIX, ARIZONA

BLM
Date
Stamp

LINE NO.	AMC NUMBER	CLAIM/SITE NAME	COUNTY RECORDER DATA (If available)	TWP	RNG	SEC
30	386124					
31	125					
32	126					
33	127					
34	128					
35	129					
36	130					
37	131					
38	132					
39	133					
40	134					
41	135					
42	136					
43	137					
44	376428					
45	429					
46	430					
47	431					
48	432					

Form MCF114
Revised June 2005

This form is available from the Arizona Department of Mines & Mineral Resources and may be reproduced.

SUPPLEMENTAL ATTACHMENT

May be used with the following forms for listing additional mining claims:

Check One.

- Affidavit of Performance of Annual Work
- Maintenance Fee Payment
- Notice of Intent to Hold Mining Claims
- Notice of Non-Liability for Labor and Materials Furnished

RECEIVED
 BLM AZ STATE OFFICE
 2012 AUG 27 A 11: 57
 PHOENIX, ARIZONA
 BLM
 Date
 Stamp

LINE NO.	AMC NUMBER	CLAIM/SITE NAME	COUNTY RECORDER DATA (If available)	TWP	RNG	SEC
49	401831	Bluerock 14				

United States Department of the Interior

Bureau of Land Management

LANDS/RECREATION & PLANNING

ONE N CENTRAL AVE

PHOENIX, AZ 85004 -2203

Phone: 602-417-9200

Receipt

No:

2641176

Transaction #: 2721815	
Date of Transaction: 08/27/2012	
CUSTOMER:	
RED HILLS MINING LLC PO BOX 1169 FLORENCE, AZ 85132-3024 US	

LINE #	QTY	DESCRIPTION	REMARKS	UNIT PRICE	TOTAL
1	1.00	LOCATABLE MINERALS / MINING CLAIMS-NOT NEW-UNADJUD, ONE AUTH NO. ONLY / MINING CLAIM MONEY RECEIVED CASES: AMC356003/\$6860.00	MAINT 2013/49	- n/a -	6860.00
TOTAL:					\$6,860.00

PAYMENT INFORMATION			
1	AMOUNT:	6860.00	POSTMARKED: N/A
	TYPE:	CHECK	RECEIVED: 08/27/2012
	CHECK NO:	1240	
	NAME:	RED HILLS MINING LLC PO BOX 1169 FLORENCE AZ 85132-3024 US	

REMARKS

This receipt was generated by the automated BLM Collections and Billing System and is a paper representation of a portion of the official electronic record contained therein.

DEPARTMENT OF THE INTERIOR
BUREAU OF LAND MANAGEMENT
MINING CLAIMS

MC Customer Information - With Serial No. and Claim Name
ACTIVE CLAIMS

Run Date: 09/07/2012 11:52 AM

Page 1 of 1

Admin State: AZ

Geo State: AZ

RED HILLS MINING LLC
4101 E TAMAYA ST
PHOENIX, AZ 85044-15

CUSTOMER ID: 2126781

<u>Serial No.</u>	<u>Claim Name/Number</u>	<u>Lead Serial No.</u>	<u>Disposition</u>
AMC356003	BLUEROCK 20	AMC356003	ACTIVE
AMC356004	BLUEROCK 21	AMC356003	ACTIVE
AMC356005	BLUEROCK 22	AMC356003	ACTIVE
AMC356059	BLUEROCK 23	AMC356059	ACTIVE
AMC356060	BLUEROCK 24	AMC356059	ACTIVE
AMC356061	BLUEROCK 25	AMC356059	ACTIVE
AMC356062	BLUEROCK 26	AMC356059	ACTIVE
AMC356063	BLUEROCK 27	AMC356059	ACTIVE
AMC356064	BLUEROCK 28	AMC356059	ACTIVE
AMC356065	BLUEROCK 29	AMC356059	ACTIVE
AMC356066	BLUEROCK 30	AMC356059	ACTIVE
AMC356067	BLUEROCK 31	AMC356059	ACTIVE
AMC356068	BLUEROCK 32	AMC356059	ACTIVE
AMC356069	BLUEROCK 33	AMC356059	ACTIVE
AMC356070	BLUEROCK 34	AMC356059	ACTIVE
AMC356071	BLUEROCK 35	AMC356059	ACTIVE
AMC356072	BLUEROCK 36	AMC356059	ACTIVE
AMC356073	BLUEROCK 37	AMC356059	ACTIVE
AMC356074	BLUEROCK 38	AMC356059	ACTIVE
AMC356075	BLUEROCK 39	AMC356059	ACTIVE
AMC356123	BLUEROCK 40	AMC356123	ACTIVE
AMC356124	BLUEROCK 41	AMC356123	ACTIVE
AMC356125	BLUEROCK 42	AMC356123	ACTIVE
AMC356126	BLUEROCK 43	AMC356123	ACTIVE
AMC356127	BLUEROCK 44	AMC356123	ACTIVE
AMC356128	BLUEROCK 45	AMC356123	ACTIVE
AMC356129	BLUEROCK 46	AMC356123	ACTIVE
AMC356130	BLUEROCK 47	AMC356123	ACTIVE
AMC356131	BLUEROCK 48	AMC356123	ACTIVE
AMC356132	BLUEROCK 49	AMC356123	ACTIVE
AMC356133	BLUEROCK 50	AMC356123	ACTIVE
AMC356134	BLUEROCK 51	AMC356123	ACTIVE
AMC356135	BLUEROCK 52	AMC356123	ACTIVE
AMC356136	BLUEROCK 53	AMC356123	ACTIVE
AMC356137	BLUEROCK 54	AMC356123	ACTIVE

Number of ACTIVE cases: 35

RED HILLS MINING LLC
PO BOX 1169
FLORENCE, AZ 85132-3

CUSTOMER ID: 2304165

<u>Serial No.</u>	<u>Claim Name/Number</u>	<u>Lead Serial No.</u>	<u>Disposition</u>
AMC401831	BLUE ROCK NUMBER 14	AMC401831	ACTIVE

Number of ACTIVE cases: 1

AMC 356003
 356059
 356123
 336106
 376428
 401831
 ENTERED INTO COMPUTER *m*

AUG 30 2011

MAINTENANCE FEE PAYMENT

Claimant Name: CLARENCE HEISTER
 Address: PO BOX 1169
 City: Florence State: AL Zip: 35232
 Telephone: 602-722-0861
 E-mail address: _____
 Signature: Clarence Heister
 Check here if this is a change of address.

RECEIVED
 PHOENIX, ARIZONA
 2011 AUG 25 P 2:08
 BLM
 Date
 Stamp

LINE NO.	AMC NUMBER	CLAIM/SITE NAME	COUNTY RECORDER DATA (If available)	TWP	RNG	SEC
1	356003	BLOERock 20				
2	004	21				
3	005	22				
4	059	23				
5	060	24				
6	061	25				
7	062	26				
8	063	27				
9	064	28				
10	065	29				

List additional claims on Form MCF114.

Bureau of Land Management
 Arizona State Office
www.az.blm.gov

No. of Claims: 409 ~~x \$125 =~~ 6,860
 Check No: 1237 Init. JML
 Receipt No.: 2415583
 For BLM Use Only

Form: MCF112
 Revised July 2005

AUG 30 2011

SUPPLEMENTAL ATTACHMENT

May be used with the following forms for listing additional mining claims:

Check One.

- Affidavit of Performance of Annual Work
- Maintenance Fee Payment
- Notice of Intent to Hold Mining Claims
- Notice of Non-Liability for Labor and Materials Furnished

RECEIVED
 PLM AZ STATE OFFICE
 2011 AUG 25 P 2:08
 PHOENIX, ARIZONA
 BLM
 Date
 Stamp

LINE NO.	AMC NUMBER	CLAIM/SITE NAME	COUNTY RECORDER DATA (If available)	TWP	RNG	SEC
30	356124					
31	125					
32	126					
33	127					
34	128					
35	129					
36	130					
37	131					
38	132					
39	133					
40	134					
41	135					
42	136					
43	137					
44	376428					
45	429					
46	430					
47	431					
48	432					

Form MCF114
 Revised June 2005

United States Department of the Interior

Bureau of Land Management

LANDS/RECREATION & PLANNING

ONE N CENTRAL AVE

PHOENIX, AZ 85004 -2203

Phone: 602-417-9200

Receipt

No:

2415583

Transaction #: 2490960

Date of Transaction: 08/25/2011

ENTERED INTO COMPUTER

AUG 30 2011

CUSTOMER:

RED HILLS MINING LLC
PO BOX 1169
FLORENCE, AZ 85132-3024 US

LINE #	QTY	DESCRIPTION	REMARKS	UNIT PRICE	TOTAL
1	1.00	LOCATABLE MINERALS / MINING CLAIMS-NOT NEW-UNADJUD, ONE AUTH NO. ONLY / MINING CLAIM MONEY RECEIVED CASES: AMC356009/\$6860.00	MAINT 2012/49	- n/a -	6860.00
TOTAL:					\$6,860.00

PAYMENT INFORMATION

1	AMOUNT:	6860.00	POSTMARKED:	N/A
	TYPE:	CHECK	RECEIVED:	08/25/2011
	CHECK NO:	1237		
	NAME:	RED HILLS MINING LLC PO BOX 1169 FLORENCE AZ 85132-3024 US		

REMARKS

This receipt was generated by the automated BLM Collections and Billing System and is a paper representation of a portion of the official electronic record contained therein.

AMC 356003
 AMC 356 059
 AMC 356123
 AMC 376428
 AMC 336106

MAINTENANCE FEE PAYMENT

Claimant Name: LARRENCE B HEISLER
 Address: PO BOX 1169
 City: FLORENCE State: AZ Zip: 85232
 Telephone: 602-722-0861
 E-mail address: _____
 Signature: Larrence B Heisler

Check here if this is a change of address.

RECEIVED
 BLM AZ STATE OFFICE
 2010 AUG 12 A 11:09
 PHOENIX, ARIZONA
 BLM
 Date
 Stamp

LINE NO.	AMC NUMBER	CLAIM/SITE NAME	COUNTY RECORDER DATA (If available)	TWP	RNG	SEC
1	356-003	Block 20				
2	004	21				
3	005	22				
4	059	23				
5	060	24				
6	061	25				
7	062	26				
8	063	27				
9	064	28				
10	065	29				

10/50

List additional claims on Form MCF114.

Bureau of Land Management
 Arizona State Office
www.az.blm.gov

No. of Claims: 48 x \$125 = 6720.
 Check No: 1231 Init. SC
 Receipt No.: 2189460
 For BLM Use Only

Form: MCF112
 Revised July 2005

SUPPLEMENTAL ATTACHMENT

May be used with the following forms for listing additional mining claims:

Check One.

- Affidavit of Performance of Annual Work
- Maintenance Fee Payment
- Notice of Intent to Hold Mining Claims
- Notice of Non-Liability for Labor and Materials Furnished

RECEIVED
BLM AZ STATE OFFICE
PHOENIX, ARIZONA
2010 AUG 12 A.M. 09
BLM
Date
Stamp

LINE NO.	AMC NUMBER	CLAIM/SITE NAME	COUNTY RECORDER DATA (If available)	TWP	RNG	SEC
	356124	Blue Rock 41				
	125	42				
	126	43				
	127	44				
	128	45				
	129	46				
	130	47				
	131	48				
	132	49				
	133	50				
	134	51				
	135	52				
	136	53				
	137	54				
	376428	55				
	429	56				
	430	57				
	431	58				
	432	59				

19/50

Form MCF114
Revised June 2005

SUPPLEMENTAL ATTACHMENT

May be used with the following forms for listing additional mining claims:

Check One.

- Affidavit of Performance of Annual Work
- Maintenance Fee Payment
- Notice of Intent to Hold Mining Claims
- Notice of Non-Liability for Labor and Materials Furnished

RECEIVED
 BLM AZ STATE OFFICE
 PHOENIX, ARIZONA
 2010 AUG 12 A 11:09
 BLM
 Date
 Stamp

LINE NO.	AMC NUMBER	CLAIM/SITE NAME	COUNTY RECORDER DATA (If available)	TWP	RNG	SEC
	336/06	BLUEROCK 1				
	107	2				
	108	3				
	109	4				
	110	9				
	114	9				
	116	11				
	121	16				
	356066	BLUEROCK 30				
	067	31				
	068	32				
	069	33				
	070	34				
	071	35				
	072	36				
	073	37				
	074	38				
	075	39				
	356123	40				

19/50

Form MCF114
 Revised June 2005

United States Department of the Interior
 Bureau of Land Management
 LANDS/RECREATION & PLANNING
 ONE N CENTRAL AVE
 PHOENIX, AZ 85004 -2203
 Phone:

Receipt

No: 2189460

ENTERED INTO COMPUTER

Transaction #: 2259174	
Date of Transaction: 08/12/2010	
CUSTOMER:	CLARENCE HEISLER PO BOX 1169 FLORENCE, AZ 85232-1169 US

AUG 19 2010

LINE #	QTY	DESCRIPTION	REMARKS	UNIT PRICE	TOTAL
1	1.00	LOCATABLE MINERALS / MINING CLAIMS-NOT NEW-UNADJUD, ONE AUTH NO. ONLY / MINING CLAIM MONEY RECEIVED CASES: AMC356003/\$6720.00	MAINT (48) 2011	- n/a -	6720.00
TOTAL:					\$6,720.00

PAYMENT INFORMATION					
1	AMOUNT:	6720.00	POSTMARKED:	N/A	
	TYPE:	CHECK	RECEIVED:	08/12/2010	
	CHECK NO:	1231			
	NAME:	HEISLER, CLARENCE PO BOX 1169 FLORENCE AZ 85232-1169 US			

REMARKS

This receipt was generated by the automated BLM Collections and Billing System and is a paper representation of a portion of the official electronic record contained therein.

AMC 356003

Authorized Date 11/24/2009

AZ BLM REFUND TO RED HILLS MINING LLC FOR \$6720
DUPLICATE PAYMENT ON AMC356003, RECEIPT #1957176,
TONY SMITH @ 602-417-9355

Instructions to Accounts SENT TO:

RED HILLS MINING LLC
P.O. BOX 1169
FLORENCE, AZ 85232

Login ID 203

Entry Date 11/24/2009

Total Amount \$6,720.00

Rem 379

Clarence Heister

602-722-0861

United States Department of the Interior
Bureau of Land Management
 BUSINESS & SUPPORT SVCS DIV
 ONE N CENTRAL AVE SUITE 800
 PHOENIX, AZ 85004 -4427
 Phone: (602) 417-9200

Receipt

No: 1957176

Transaction #: 2020837	
Date of Transaction: 07/14/2009	
CUSTOMER:	RED HILLS MINING LLC PO BOX 1169 FLORENCE, AZ 85232-1169 US

LINE #	QTY	DESCRIPTION	REMARKS	UNIT PRICE	TOTAL
1	1.00	SUSPENSE, MISCELLANEOUS / SUSPENSE, MISCELLANEOUS / TEMPORARY HOLD (1 WEEK ONLY)		6720.00	6720.00
TOTAL:					\$6,720.00

PAYMENT INFORMATION			
1	AMOUNT:	6720.00	POSTMARKED: N/A
	TYPE:	CHECK	RECEIVED: 07/14/2009
	CHECK NO:	1226	
	NAME:	RED HILLS MINING LLC PO BOX 1169 FLORENCE AZ 85232-1169 US	

REMARKS
REFERENCE RECEIPT: 1954309 DATED 07/09/09. DID NOT DEPOSIT ON 07/09/09 ON DEPOSIT TICKET-192650.

This receipt was generated by the automated BLM Collections and Billing System and is a paper representation of a portion of the official electronic record contained therein.

Dup. payment! overpaid! prev paid on # 1954309!
 See att.
 Refund Red Hills

United States Department of the Interior
Bureau of Land Management
 BUSINESS & SUPPORT SVCS DIV
 ONE N CENTRAL AVE SUITE 800
 PHOENIX, AZ 85004 -4427
 Phone: (602) 417-9200

Receipt

No: 1954309

Transaction #: 2017904	
Date of Transaction: 07/09/2009	
CUSTOMER:	CLARENCE HEISLER PO BOX 1169 FLORENCE, AZ 85232-1169 US

LINE #	QTY	DESCRIPTION	REMARKS	UNIT PRICE	TOTAL
1	1.00	LOCATABLE MINERALS / MINING CLAIMS- NOT NEW-UNADJUD, ONE AUTH NO. ONLY / MINING CLAIM MONEY RECEIVED CASES: AMC356003/\$6720.00	MAINT 2010 (48)	- n/a -	6720.00
TOTAL:					\$6,720.00

PAYMENT INFORMATION			
1	AMOUNT:	-6720.00	POSTMARKED: N/A
	TYPE:	CHECK (REFUND OR DEBIT VOUCHER)	RECEIVED: 07/09/2009
	CHECK NO:	1226	
	NAME:	HEISLER, CLARENCE PO BOX 1169 FLORENCE AZ 85232-1169 US	
2	AMOUNT:	6720.00	POSTMARKED: N/A
	TYPE:	CHECK	RECEIVED: 07/09/2009
	CHECK NO:	1226	
	NAME:	HEISLER, CLARENCE PO BOX 1169 FLORENCE AZ 85232-1169 US	

REMARKS

This receipt was generated by the automated BLM Collections and Billing System and is a paper representation of a portion of the official electronic record contained therein.

48 claims ran on this receipt. earned

**DEPARTMENT OF THE INTERIOR
BUREAU OF LAND MANAGEMENT
MINING CLAIMS**

**MC Customer Information - With OUT Legal Description
ACTIVE, CLOSED CLAIMS**

Run Date: 10/20/2009 11:30 AM

Page 3 of 3

**P.M. EXPL LLC
2207 CRESCENT DR
DODGE CITY, KS 67801**

INT-REL: CLAIMANT

CUSTOMER ID: 2264175

+ Pete Myers

<u>Serial No</u>	<u>Claim Name/Number</u>	<u>County</u>	<u>Disposition</u>	<u>Int Rel</u>
AMC361755	N.D. #10	COCHISE	ACTIVE	CLAIMANT
AMC361756	N.D. #11	COCHISE	ACTIVE	CLAIMANT
AMC361955	N.D.#12	COCHISE	ACTIVE	CLAIMANT
AMC361956	N.D.#13	COCHISE	ACTIVE	CLAIMANT

**RED HILLS MINING LLC
4101 E TAMAYA ST
PHOENIX, AZ 85044**

INT-REL: CLAIMANT

CUSTOMER ID: 2126781

<u>Serial No</u>	<u>Claim Name/Number</u>	<u>County</u>	<u>Disposition</u>	<u>Int Rel</u>
2- AMC356003 ✓	BLUEROCK 20	PINAL	ACTIVE	CLAIMANT
AMC356004 ✓	BLUEROCK 21	PINAL	ACTIVE	CLAIMANT
AMC356005 ✓	BLUEROCK 22	PINAL	ACTIVE	CLAIMANT
AMC356059 ✓	BLUEROCK 23	PINAL	ACTIVE	CLAIMANT
AMC356060 ✓	BLUEROCK 24	PINAL	ACTIVE	CLAIMANT
AMC356061 ✓	BLUEROCK 25	PINAL	ACTIVE	CLAIMANT
AMC356062 ✓	BLUEROCK 26	PINAL	ACTIVE	CLAIMANT
AMC356063 ✓	BLUEROCK 27	PINAL	ACTIVE	CLAIMANT
AMC356064 ✓	BLUEROCK 28	PINAL	ACTIVE	CLAIMANT
AMC356065 ✓	BLUEROCK 29	PINAL	ACTIVE	CLAIMANT
AMC356066 ✓	BLUEROCK 30	PINAL	ACTIVE	CLAIMANT
AMC356067 ✓	BLUEROCK 31	PINAL	ACTIVE	CLAIMANT
AMC356068 ✓	BLUEROCK 32	PINAL	ACTIVE	CLAIMANT
AMC356069 ✓	BLUEROCK 33	PINAL	ACTIVE	CLAIMANT
AMC356070 ✓	BLUEROCK 34	PINAL	ACTIVE	CLAIMANT
AMC356071 ✓	BLUEROCK 35	PINAL	ACTIVE	CLAIMANT
AMC356072 ✓	BLUEROCK 36	PINAL	ACTIVE	CLAIMANT
AMC356073 ✓	BLUEROCK 37	PINAL	ACTIVE	CLAIMANT
AMC356074 ✓	BLUEROCK 38	PINAL	ACTIVE	CLAIMANT
AMC356075 ✓	BLUEROCK 39	PINAL	ACTIVE	CLAIMANT
3- AMC356123 ✓	BLUEROCK 40	PINAL	ACTIVE	CLAIMANT
AMC356124 ✓	BLUEROCK 41	PINAL	ACTIVE	CLAIMANT
AMC356125 ✓	BLUEROCK 42	PINAL	ACTIVE	CLAIMANT
AMC356126 ✓	BLUEROCK 43	PINAL	ACTIVE	CLAIMANT
AMC356127 ✓	BLUEROCK 44	PINAL	ACTIVE	CLAIMANT
AMC356128 ✓	BLUEROCK 45	PINAL	ACTIVE	CLAIMANT
AMC356129 ✓	BLUEROCK 46	PINAL	ACTIVE	CLAIMANT
AMC356130 ✓	BLUEROCK 47	PINAL	ACTIVE	CLAIMANT
AMC356131 ✓	BLUEROCK 48	PINAL	ACTIVE	CLAIMANT
AMC356132 ✓	BLUEROCK 49	PINAL	ACTIVE	CLAIMANT
AMC356133 ✓	BLUEROCK 50	PINAL	ACTIVE	CLAIMANT
AMC356134 ✓	BLUEROCK 51	PINAL	ACTIVE	CLAIMANT
AMC356135 ✓	BLUEROCK 52	PINAL	ACTIVE	CLAIMANT
AMC356136 ✓	BLUEROCK 53	PINAL	ACTIVE	CLAIMANT
AMC356137 ✓	BLUEROCK 54	PINAL	ACTIVE	CLAIMANT

2- AMC356003 ✓
3- AMC356123 ✓
35

Paid & Accepted
(48) Export receipt # 1954309

*336 106, 7, 8, 9, 10, 11, 4,
116, 121,*

3764 28, 29, 30, 31, 32.

**DEPARTMENT OF THE INTERIOR
BUREAU OF LAND MANAGEMENT
MINING CLAIMS**

**MC Customer Information - With OUT Legal Description
ACTIVE, CLOSED CLAIMS**

Run Date: 10/20/2009 11:46 AM

Page 1 of 2

**BOLINGER JESSE E
7811 S NAVAJO AVE
GLOBE, AZ 85501-4072**

INT-REL: CLAIMANT

CUSTOMER ID: 2277866

<u>Serial No</u>	<u>Claim Name/Number</u>	<u>County</u>	<u>Disposition</u>	<u>Int Rel</u>
1. AMC336106 ✓	BLUEROCK #1	PINAL	ACTIVE	CLAIMANT
AMC336107 ✓	BLUEROCK #2	PINAL	ACTIVE	CLAIMANT
AMC336108 ✓	BLUEROCK #3	PINAL	ACTIVE	CLAIMANT
AMC336109 ✓	BLUEROCK #4	PINAL	ACTIVE	CLAIMANT
AMC336110 ✓	BLUEROCK #5	PINAL	ACTIVE	CLAIMANT
AMC336114 ✓	BLUEROCK #9	PINAL	ACTIVE	CLAIMANT
AMC336116 ✓	BLUEROCK #11	PINAL	ACTIVE	CLAIMANT
AMC336121 ✓	BLUEROCK #16	PINAL	ACTIVE	CLAIMANT

**BOLINGER JESSEE
BOX 1169
FLORENCE, AZ 85232**

INT-REL: CLAIMANT

CUSTOMER ID: 2243583

<u>Serial No</u>	<u>Claim Name/Number</u>	<u>County</u>	<u>Disposition</u>	<u>Int Rel</u>
H AMC376428 ✓	BLUEROCK 55	PINAL	ACTIVE	CLAIMANT
AMC376429 ✓	BLUEROCK 56	PINAL	ACTIVE	CLAIMANT
AMC376430 ✓	BLUEROCK 57	PINAL	ACTIVE	CLAIMANT
AMC376431 ✓	BLUEROCK 58	PINAL	ACTIVE	CLAIMANT
AMC376432 ✓	BLUEROCK 59	PINAL	ACTIVE	CLAIMANT

**HEISLER CLARENCE
7955 E CHAPARRAL #9
SCOTTSDALE, AZ 85250**

INT-REL: CLAIMANT

CUSTOMER ID: 31870

<u>Serial No</u>	<u>Claim Name/Number</u>	<u>County</u>	<u>Disposition</u>	<u>Int Rel</u>
AMC336111	BLUEROCK #6	PINAL	CLOSED	CLAIMANT
AMC336112	BLUEROCK #7	PINAL	CLOSED	CLAIMANT
AMC336113	BLUEROCK #8	PINAL	CLOSED	CLAIMANT
AMC336115	BLUEROCK #10	PINAL	CLOSED	CLAIMANT
AMC336117	BLUEROCK #12	PINAL	CLOSED	CLAIMANT
AMC336118	BLUEROCK #13	PINAL	CLOSED	CLAIMANT
AMC336119	BLUEROCK #14	PINAL	CLOSED	CLAIMANT
AMC336120	BLUEROCK #15	PINAL	CLOSED	CLAIMANT
AMC336122	BLUEROCK #17	PINAL	CLOSED	CLAIMANT
AMC336123	BLUEROCK #18	PINAL	CLOSED	CLAIMANT
AMC336124	BLUEROCK #19	PINAL	CLOSED	CLAIMANT

**HEISLER CLARENCE
BOX 1169
FLORENCE, AZ 85232**

INT-REL: CLAIMANT

CUSTOMER ID: 2243582

<u>Serial No</u>	<u>Claim Name/Number</u>	<u>County</u>	<u>Disposition</u>	<u>Int Rel</u>
AMC376428 ✓	BLUEROCK 55	PINAL	ACTIVE	CLAIMANT
AMC376429 ✓	BLUEROCK 56	PINAL	ACTIVE	CLAIMANT
AMC376430 ✓	BLUEROCK 57	PINAL	ACTIVE	CLAIMANT
AMC376431 ✓	BLUEROCK 58	PINAL	ACTIVE	CLAIMANT
AMC376432 ✓	BLUEROCK 59	PINAL	ACTIVE	CLAIMANT

**DEPARTMENT OF THE INTERIOR
BUREAU OF LAND MANAGEMENT
MINING CLAIMS**

**MC Customer Information - With OUT Legal Description
ACTIVE, CLOSED CLAIMS**

Run Date: 10/20/2009 11:46 AM

Page 2 of 2

**HEISLER CLARENCE
BOX 937
GLOBE, AZ 85502**

INT-REL: CLAIMANT

CUSTOMER ID: 31871

<u>Serial No</u>	<u>Claim Name/Number</u>	<u>County</u>	<u>Disposition</u>	<u>Int Rel</u>
AMC336106 ✓	BLUEROCK #1	PINAL	ACTIVE	CLAIMANT
AMC336107 ✓	BLUEROCK #2	PINAL	ACTIVE	CLAIMANT
AMC336108 ✓	BLUEROCK #3	PINAL	ACTIVE	CLAIMANT
AMC336109 ✓	BLUEROCK #4	PINAL	ACTIVE	CLAIMANT
AMC336110 ✓	BLUEROCK #5	PINAL	ACTIVE	CLAIMANT
AMC336114 ✓	BLUEROCK #9	PINAL	ACTIVE	CLAIMANT
AMC336116 ✓	BLUEROCK #11	PINAL	ACTIVE	CLAIMANT
AMC336121 ✓	BLUEROCK #16	PINAL	ACTIVE	CLAIMANT

13

**HEISLER CLARK B
BOX 937
GLOBE, AZ 85502**

INT-REL: CLAIMANT

CUSTOMER ID: 31872

<u>Serial No</u>	<u>Claim Name/Number</u>	<u>County</u>	<u>Disposition</u>	<u>Int Rel</u>
AMC350670	CALIFORNIA	GILA	CLOSED	CLAIMANT
AMC350671	CHALLENGE	GILA	CLOSED	CLAIMANT
AMC350672	DELINQUENT	GILA	CLOSED	CLAIMANT
AMC350673	EAST PIONEER	GILA	CLOSED	CLAIMANT
AMC350674	NORTH REPUBLIC	GILA	CLOSED	CLAIMANT
AMC355002	EAST PIONEER	GILA	CLOSED	CLAIMANT
AMC355003	CHALLENGE	GILA	CLOSED	CLAIMANT
AMC355004	DELINQUENT	GILA	CLOSED	CLAIMANT
AMC355005	CALIFORNIA	GILA	CLOSED	CLAIMANT
AMC355006	NORTH REPUBLIC	GILA	CLOSED	CLAIMANT

AMC 356003
 356059
 356123
 376428
 336186

MAINTENANCE FEE PAYMENT

Claimant Name: CLARENCE HEISLER
 Address: PO BOX 1169
 City: Flagstaff State: AZ Zip: 85232
 Telephone: 602-722-0861
 E-mail address: _____
 Signature: Clarence Heisler

RECEIVED
 ARIZONA STATE OFFICE
 2009 JUL - 9 P 1:16
 PHOENIX, ARIZONA
 BLM
 Date
 Stamp

Check here if this is a change of address.

LINE NO.	AMC NUMBER	CLAIM/SITE NAME	COUNTY RECORDER DATA (If available)	TWP	RNG	SEC
1	L 356-003	Blue rock 20				
2	004	21				
3	005	22				
4	L 059	23				
5	060	24				
6	061	25				
7	062	26				
8	063	27				
9	064	28				
10	065	29				

List additional claims on Form MCF114.

Bureau of Land Management
 Arizona State Office
www.az.blm.gov

No. of Claims: 48 x \$125 = 6,000.00
 Check No: 1226 Init. SC
 Receipt No.: 1954309
 For BLM Use Only

Form: MCF112
 Revised July 2005

This form is available from the Arizona Department of Mines and Mineral Resources and may be reproduced.

ENTERED INTO COMPUTER

7/23/09 DJJ

SUPPLEMENTAL ATTACHMENT

May be used with the following forms for listing additional mining claims:

Check One.

- Affidavit of Performance of Annual Work
- Maintenance Fee Payment
- Notice of Intent to Hold Mining Claims
- Notice of Non-Liability for Labor and Materials Furnished

RECEIVED
 DEPARTMENT OF MINES AND METALS
 ARIZONA STATE OFFICE
 2009 JUL -9 P 1:16
 PHOENIX, ARIZONA
 BLM
 Date
 Stamp

LINE NO.	AMC NUMBER	CLAIM/SITE NAME	COUNTY RECORDER DATA (If available)	TWP	RNG	SEC
L	336106	BLUEROCK 1				
	107	2				
	108	3				
	109	4				
	110	5				
	114	9				
	116	11				
	121	16				
	356 066	BLUEROCK 30				
	067	31				
	068	32				
	069	33				
	070	34				
	071	35				
	072	36				
	073	37				
	074	38				
	075	39				
L	356123	40				

Form MCF114
 Revised June 2005

SUPPLEMENTAL ATTACHMENT

May be used with the following forms for listing additional mining claims:

Check One.

- Affidavit of Performance of Annual Work
- Maintenance Fee Payment
- Notice of Intent to Hold Mining Claims
- Notice of Non-Liability for Labor and Materials Furnished

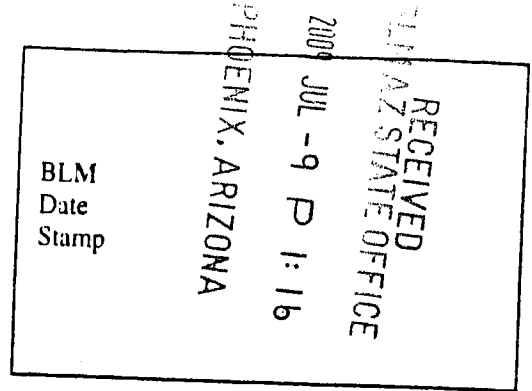

LINE NO.	AMC NUMBER	CLAIM/SITE NAME	COUNTY RECORDER DATA (If available)	TWP	RNG	SEC
	356 124					
	125					
	126					
	127					
	128					
	129					
	130					
	131					
	132					
	133					
	134					
	135					
	136					
	137					
L	376428					
	429					
	430					
	431					
	432					

Form MCF114
Revised June 2005

This form is available from the Arizona Department of Mines & Mineral Resources and may be reproduced.

United States Department of the Interior

Bureau of Land Management
 BUSINESS & SUPPORT SVCS DIV
 ONE N CENTRAL AVE SUITE 800
 PHOENIX, AZ 85004 -4427
 Phone: (602) 417-9200

Receipt

No: 1954309

Transaction #: 2017904	
Date of Transaction: 07/09/2009	
CUSTOMER:	CLARENCE HEISLER PO BOX 1169 FLORENCE, AZ 85232-1169 US

LINE #	QTY	DESCRIPTION	REMARKS	UNIT PRICE	TOTAL
1	1.00	LOCATABLE MINERALS / MINING CLAIMS-NOT NEW-UNADJUD, ONE AUTH NO. ONLY / MINING CLAIM MONEY RECEIVED CASES: AMC356003/\$6720.00	MAINT 2010 (48)	- n/a -	6720.00
TOTAL:					\$6,720.00

PAYMENT INFORMATION			
1	AMOUNT:	6720.00	POSTMARKED: N/A
	TYPE:	CHECK	RECEIVED: 07/09/2009
	CHECK NO:	1226	
	NAME:	HEISLER, CLARENCE PO BOX 1169 FLORENCE AZ 85232-1169 US	

REMARKS

This receipt was generated by the automated BLM Collections and Billing System and is a paper representation of a portion of the official electronic record contained therein.

Amc 356003
 Amc 356123
 Amc 376428
 Amc 336106
 Amc 356059

MAINTENANCE FEE PAYMENT

Claimant Name: CLARENCE HEISLER
 Address: PO Box 1169
 City: Florence State: AZ Zip: 85232
 Telephone: 602-722-0861
 E-mail address: _____
 Signature: Clarence Heisler

Check here if this is a change of address.

RECEIVED
 BLM AZ STATE OFFICE
 2008 AUG 27 A 11:03
 PHOENIX, ARIZONA
 BLM
 Date
 Stamp

LINE NO.	AMC NUMBER	CLAIM/SITE NAME	COUNTY RECORDER DATA (If available)	TWP	RNG	SEC
1	356-003	BLUEROCK 20				
2	004	21				
3	005	22				
4	009	23				
5	060	24				
6	061	25				
7	062	26				
8	063	27				
9	064	28				
10	065	29				

List additional claims on Form MCF114.

No. of Claims: 48 x \$125 = 6,000.
 Check No: 1219 Init. SC
 Receipt No.: 1772539
 For BLM Use Only

Bureau of Land Management
 Arizona State Office
www.az.blm.gov

Form: MCF112
 Revised July 2005

This form is available from the Arizona Department of Mines and Mineral Resources and may be reproduced.

ENTERED INTO COMPUTER
 SEP 16 '08

10/50

SUPPLEMENTAL ATTACHMENT

May be used with the following forms for listing additional mining claims:

Check One.

- Affidavit of Performance of Annual Work
- Maintenance Fee Payment
- Notice of Intent to Hold Mining Claims
- Notice of Non-Liability for Labor and Materials Furnished

RECEIVED
BLM AZ STATE OFFICE
2008 AUG 27 AM 11:03
PHOENIX, ARIZONA

BLM
Date
Stamp

LINE NO.	AMC NUMBER	CLAIM/SITE NAME	COUNTY RECORDER DATA (If available)	TWP	RNG	SEC
	336106	Bluerock 1				
	107	2				
	108	3				
	109	4				
	110	5				
	114	9				
	116	11				
	121	16				
	356066	Bluerock 30				
	067	31				
	068	32				
	069	33				
	070	34				
	071	35				
	072	36				
	073	37				
	074	38				
	075	39				
	356123	40				

Form MCF114
Revised June 2005

This form is available from the Arizona Department of Mines & Mineral Resources and may be reproduced.

19/58

SUPPLEMENTAL ATTACHMENT

May be used with the following forms for listing additional mining claims:

Check One.

- Affidavit of Performance of Annual Work
- Maintenance Fee Payment
- Notice of Intent to Hold Mining Claims
- Notice of Non-Liability for Labor and Materials Furnished

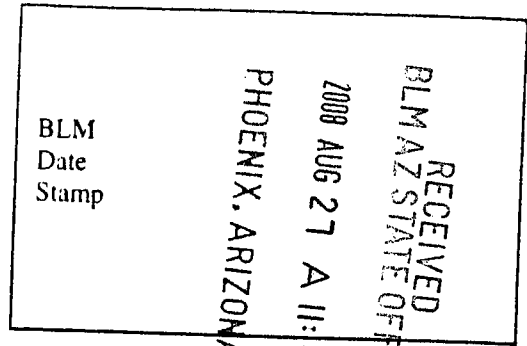

LINE NO.	AMC NUMBER	CLAIM/SITE NAME	COUNTY RECORDER DATA (If available)	TWP	RNG	SEC
	356124	BLOEROCK 41				
	125	42				
	126	43				
	127	44				
	128	45				
	129	46				
	130	47				
	131	48				
	132	49				
	133	50				
	134	51				
	135	52				
	136	53				
	137	54				
	376428	55				
	429	56				
	430	57				
	431	58				
	432	59				

Form MCF114
Revised June 2005

This form is available from the Arizona Department of Mines & Mineral Resources and may be reproduced.

109/50

United States Department of the Interior
Bureau of Land Management
 BUSINESS & SUPPORT SVCS DIV
 ONE N CENTRAL AVE SUITE 800
 PHOENIX, AZ 85004 -4427
 Phone: (602) 417-9200

Receipt

No: 1772539

Transaction #: 1830261	
Date of Transaction: 08/27/2008	
CUSTOMER:	CLARENCE HEISLER PO BOX 1169 FLORENCE, AZ 85232

LINE #	QTY	DESCRIPTION	REMARKS	UNIT PRICE	TOTAL
1	1.00	LOCATABLE MINERALS / MINING CLAIMS-NOT NEW-UNADJUD, ONE AUTH NO. ONLY / MINING CLAIM MONEY RECEIVED (455) CASES: AMC356003/\$6000.00	MAINT 2009 (48)	- n/a -	6000.00
TOTAL:					\$6,000.00

PAYMENT INFORMATION			
1	AMOUNT:	\$6,000.00	POSTMARKED: N/A
	TYPE:	CHECK	RECEIVED: 08/27/2008
	CHECK NO:	1219	
	NAME:	HEISLER, CLARENCE PO BOX 1169 FLORENCE AZ 85232	

REMARKS

This receipt was generated by the automated BLM Collections and Billing System and is a paper representation of a portion of the official electronic record contained therein.

AMC 356003
 AMC 356059
 AMC 336106
 AMC 356123
 AMC 376428

MAINTENANCE FEE PAYMENT

Claimant Name: Clarene Heister
 Address: PO Box 1169
 City: Florence State: AZ Zip: 85232
 Telephone: 602 722-0861
 E-mail address: _____
 Signature: Clarene Heister

RECEIVED
 BLM, AZ STATE OFFICE
 2001 AUG 28 P 2:17
 PHOENIX, ARIZONA
 BLM
 Date
 Stamp

Check here if this is a change of address.

LINE NO.	AMC NUMBER	CLAIM/SITE NAME	COUNTY RECORDER DATA (If available)	TWP	RNG	SEC
1	356066	Bluerich 30				
2	067	31				
3	68	32				
4	69	33				
5	70	34				
6	71	35				
7	72	36				
8	73	37				
9	74	38				
10	75	39				

List additional claims on Form MCF114.

No. of Claims: 48 x \$125 = 6000.00
 Check No: 1197 Init. EKH
 Receipt No.: 1555434
 For BLM Use Only

Bureau of Land Management
 Arizona State Office
www.az.blm.gov

Form: MCF112
 Revised July 2005

This form is available from the Arizona Department of Mines and Mineral Resources and may be reproduced.

22 9/20/07

MAINTENANCE FEE PAYMENT

Claimant Name: CLARENCE HEISTER/REDHILLS
 Address: PO BOX 1169
 City: FLORENCE State: AZ Zip: 85232
 Telephone: 602722-0861 - 928-425-3812
 E-mail address: _____
 Signature: Clarence Heister

RECEIVED
 BLM, AZ STATE OFFICE
 2007 AUG 28 P 2: 17
 PHOENIX, ARIZONA
 BLM
 Date
 Stamp

Check here if this is a change of address.

LINE NO.	AMC NUMBER	CLAIM/SITE NAME	COUNTY RECORDER DATA (If available)	TWP	RNG	SEC
1	356123	Blue Rock 40				
2	124	41				
3	125	42				
4	126	43				
5	127	44				
6	128	45				
7	129	46				
8	130	47				
9	131	48				
10	132	49				

10
 496

List additional claims on Form MCF114.

No. of Claims: _____ x \$125 = _____
 Check No: _____ Init. _____
 Receipt No.: _____
For BLM Use Only

Bureau of Land Management
Arizona State Office
www.az.blm.gov

Form: MCF112
 Revised July 2005

This form is available from the **Arizona Department of Mines and Mineral Resources** and may be reproduced.

SUPPLEMENTAL ATTACHMENT

May be used with the following forms for listing additional mining claims:

Check One.

- Affidavit of Performance of Annual Work
- Maintenance Fee Payment
- Notice of Intent to Hold Mining Claims
- Notice of Non-Liability for Labor and Materials Furnished

RECEIVED
BLM, AZ STATE OFFICE
PHOENIX, ARIZONA
2001 AUG 28 P 2:11

BLM
Date
Stamp

LINE NO.	AMC NUMBER	CLAIM/SITE NAME	COUNTY RECORDER DATA (If available)	TWP	RNG	SEC
	356003	Bluesch 20				
	04	21				
	05	22				
	059	23				
	060	24				
	061	25				
	062	26				
	063	27				
	064	28				
	065	29				
	336106	1				
	336107	2				
	336108	3				
	336109	4				
	336110	5				
	336114	9				
	336116	11				
	336121	16				

(18294)

Form MCF114
Revised June 2005

This form is available from the Arizona Department of Mines & Mineral Resources and may be reproduced.

SUPPLEMENTAL ATTACHMENT

May be used with the following forms for listing additional mining claims:

Check One.

- Affidavit of Performance of Annual Work
- Maintenance Fee Payment
- Notice of Intent to Hold Mining Claims
- Notice of Non-Liability for Labor and Materials Furnished

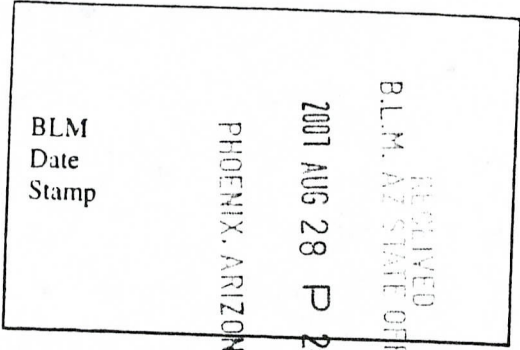

LINE NO.	AMC NUMBER	CLAIM/SITE NAME	COUNTY RECORDER DATA (If available)	TWP	RNG	SEC
	356133	Blue Rock SO				
	134	S1				
	135	S2				
	136	S3				
	137	S4				
	376428	S5				
	376429	S6				
	376430	S7				
	376431	S8				
10 EXG	376432	S9				

Form MCF114
Revised June 2005

This form is available from the Arizona Department of Mines & Mineral Resources and may be reproduced.

United States Department of the Interior
Bureau of Land Management
 BUSINESS & SUPPORT SVCS DIV
 ONE N CENTRAL AVE SUITE 800
 PHOENIX, AZ 85004 -4427
 Phone: (602) 417-9200

Receipt

No: 1555434

Transaction #: 1606998	
Date of Transaction: 08/28/2007	
CUSTOMER:	RED HILLS MINING LLC P. O. BOX 1169 FLORENCE, AZ 85232

LINE #	QTY	DESCRIPTION	REMARKS	UNIT PRICE	TOTAL
1	1.00	LOCATABLE MINERALS / MINING CLAIMS- NOT NEW-UNADJUD, ONE AUTH NO. ONLY / MINING CLAIM MONEY RECEIVED (455) CASES: AMC356066/\$6000.00	MAINT 2008 (48)	- n/a -	6000.00
TOTAL:					\$6,000.00

PAYMENT INFORMATION			
1	AMOUNT:	\$6,000.00	POSTMARKED: N/A
	TYPE:	CHECK	RECEIVED: 08/28/2007
	CHECK NO:	1197	
	NAME:	RED HILLS MINING LLC P. O. BOX 1169 FLORENCE AZ 85232	

REMARKS

This receipt was generated by the automated BLM Collections and Billing System and is a paper representation of a portion of the official electronic record contained therein.

RS 9/20/07

AMC 356123
 356059
 356003
 336106

MAINTENANCE FEE PAYMENT

Claimant Name: CLARKHESTER/REDHILLS
 Address: PO BOX 1169
 City: Florence State: AZ Zip: 85232
 Telephone: 602-722-0861
 E-mail address: _____
 Signature: [Signature]

RECEIVED
 U.S. BUREAU OF LAND MANAGEMENT
 U.S. DEPARTMENT OF THE INTERIOR
 PHOENIX, AZ
 2006 AUG 15 P 2:33
 BLM
 Date
 Stamp

Check here if this is a change of address.

LINE NO.	AMC NUMBER	CLAIM/SITE NAME	COUNTY RECORDER DATA (If available)	TWP	RNG	SEC
1	356123	BLUEROCK 40				
2	124	41				
3	125	42				
4	126	43				
5	127	44				
6	128	45				
7	129	46				
8	130	47				
9	131	48				
10	132	49				

List additional claims on Form MCF114.

Bureau of Land Management
 Arizona State Office
www.az.blm.gov

No. of Claims: 15 x \$125 = 1875.
 Check No: 1188 Init. [Signature]
 Receipt No.: 1335033
 For BLM Use Only

Form: MCF112
 Revised July 2005

This form is available from the Arizona Department of Mines and Mineral Resources and may be reproduced.

RE 8/21/06

ENTERED BY COMPUTER

MAINTENANCE FEE PAYMENT

Claimant Name: CLARKHEISLER
 Address: PO Box 1169
 City: Florence State: AZ Zip: 85232
 Telephone: 6027220861
 E-mail address: _____
 Signature: Clark

Check here if this is a change of address.

RECEIVED
 B.L.M. AZ STATE OFFICE
 2006 AUG 15 P 2:33
 PHOENIX, AZ
 BLM
 Date
 Stamp

LINE NO.	AMC NUMBER	CLAIM/SITE NAME	COUNTY RECORDER DATA (If available)	TWP	RNG	SEC
1	356066	Blue Rock 30				
2	067	31				
3	68	32				
4	69	33				
5	70	34				
6	71	35				
7	72	36				
8	73	37				
9	74	38				
10	75	39				

List additional claims on Form MCF114.

Bureau of Land Management
 Arizona State Office
www.az.blm.gov

No. of Claims: 28 x \$125 = 3500.
 Check No: 1188 Init. YES
 Receipt No.: 1335033
 For BLM Use Only

Form: MCF112
 Revised July 2005

This form is available from the Arizona Department of Mines and Mineral Resources and may be reproduced.

SUPPLEMENTAL ATTACHMENT

May be used with the following forms for listing additional mining claims:

Check One.

- Affidavit of Performance of Annual Work
- Maintenance Fee Payment
- Notice of Intent to Hold Mining Claims
- Notice of Non-Liability for Labor and Materials Furnished

RECEIVED
B.L.M. AZ STATE OFFICE
2006 AUG 15 P 2:53
PHOENIX, AZ
BLM
Date
Stamp

LINE NO.	AMC NUMBER	CLAIM/SITE NAME	COUNTY RECORDER DATA (If available)	TWP	RNG	SEC
	356003	Blue Rock 20				
	04	21				
	05	22				
	059	23				
	060	24				
	061	25				
	062	26				
	063	27				
	064	28				
	065	29				
	336106	1				
	336107	2				
	336108	3				
	336109	4				
	336110	5				
	336114	9				
	336116	11				
	336121	16				

Form MCF114
Revised June 2005

This form is available from the **Arizona Department of Mines & Mineral Resources** and may be reproduced.

United States Department of the Interior
Bureau of Land Management
 BUSINESS & SUPPORT SVCS DIV
 ONE N CENTRAL AVE
 PHOENIX, AZ 85004 -2203
 Phone: (602) 417-9200

Receipt

No: 1335033

AMC 356123
AMC 356059
AMC 356003
AMC 336106

Transaction #: 1380139	
Date of Transaction: 08/15/2006	
CUSTOMER:	RED HILLS MINING LLC P. O. BOX 1169 FLORENCE, AZ 85232

LINE #	QTY	DESCRIPTION	REMARKS	UNIT PRICE	TOTAL
1	1.00	LOCATABLE MINERALS / MINING CLAIMS-NOT NEW-UNADJUD, ONE AUTH NO. ONLY / MINING CLAIM MONEY RECEIVED (455) CASES: AMC356123/\$5375.00	MAINT 2007 (43)	- n/a -	5375.00
TOTAL:					\$5,375.00

PAYMENT INFORMATION			
1	AMOUNT:	\$5,375.00	POSTMARKED: N/A
	TYPE:	CHECK	RECEIVED: 08/15/2006
	CHECK NO:	1188	
	NAME:	RED HILLS MINING LLC P. O. BOX 1169 FLORENCE AZ 85232	

REMARKS

This receipt was generated by the automated BLM Collections and Billing System and is a paper representation of a portion of the official electronic record contained therein.

RE 8/21/06
 ENT...

AMC 336106
 AMC 356123
 AMC 356059
 AMC 356003

MAINTENANCE FEE PAYMENT

Claimant Name: CLARK HESTER REDHILLS
 Address: PO BOX 1169
 City: Florene State: AZ Zip: 85232
 Telephone: 6027220861
 E-mail address: _____
 Signature: [Signature]

Check here if this is a change of address.

RECEIVED
 B.L.M. AZ STATE OFFICE
 2005 AUG 24 P 12:13
 PHOENIX, ARIZONA
 BLM
 Date
 Stamp

LINE NO.	AMC NUMBER	CLAIM/SITE NAME	COUNTY RECORDER DATA (If available)	TWP	RNG	SEC
1	356123	Bluerock 40				
2	356124	41				
3	356125	42				
4	356126	43				
5	356127	44				
6	356128	45				
7	356129	46				
8	356130	47				
9	356131	48				
10	356132	49				

List additional claims on Form MCF114.

Bureau of Land Management
 Arizona State Office
www.az.blm.gov

No. of Claims: 10 x \$125 = 1,250
 Check No: 1176 Init. TMC
 Receipt No.: 1136368
 For BLM Use Only

Form: MCF112
 Revised July 2005

This form is available from the Arizona Department of Mines and Mineral Resources and may be reproduced.

ENTERED IN COMPUTER
 RE 8/31/05

MAINTENANCE FEE PAYMENT

Claimant Name: CLARK HEWSON/REDHILLS
 Address: PO Box 1169
 City: Florence State: AZ Zip: 85037
 Telephone: 6027220861
 E-mail address: _____
 Signature: Clark Hewson

Check here if this is a change of address.

RECEIVED
 B.L.M. AZ STATE OFFICE
 PHOENIX, ARIZONA
 2005 AUG 24 P 12:13
 BLM
 Date
 Stamp

LINE NO	AMC NUMBER	CLAIM/SITE NAME	COUNTY RECORDER DATA (if available)	TWP	RNG	SEC
1	396133	BLUE ROCK 50				
2	356134	51				
3	356135	52				
4	356136	53				
5	356137	54				
6						
7						
8						
9						
10						

List additional claims on Form MCF114.

Bureau of Land Management
 Arizona State Office
www.az.blm.gov

No. of Claims: 5 x \$125 = 625
 Check No: 1176 Init. YMC
 Receipt No.: 1136368
 For BLM Use Only

Form: MCF112
 Revised July 2005

This form is available from the Arizona Department of Mines and Mineral Resources and may be reproduced.

ENTERED IN COMPUTER
 RE 8/31/06

MAINTENANCE FEE PAYMENT

Claimant Name: CLARK HESTLEY
 Address: PO BOX 1169
 City: Flagstaff State: AZ Zip: 86001
 Telephone: 602 722 0861
 E-mail address: _____
 Signature: Clark Hestley

Check here if this is a change of address.

RECEIVED
 B.L.M. AZ STATE OFFICE
 PHOENIX, ARIZONA
 2005 AUG 24 P 12:13
 BLM
 Date
 Stamp

LINE NO.	AMC NUMBER	CLAIM/SITE NAME	COUNTY RECORDER DATA (If available)	TWP	RNG	SEC
1	356066	Blue Rock 30				
2	356067	31				
3	356068	32				
4	356069	33				
5	356070	34				
6	356071	35				
7	356072	36				
8	356073	37				
9	356074	38				
10	356075	39				

List additional claims on Form MCF114.

Bureau of Land Management
 Arizona State Office
www.az.blm.gov

No. of Claims: 10 x \$125 = 1,250
 Check No: 1176 Init. JMC
 Receipt No.: 1136368
 For BLM Use Only

Form: MCF112
 Revised July 2005

This form is available from the Arizona Department of Mines and Mineral Resources and may be reproduced.

ENTERED IN COMPUTER
 RE 8/31/06

MAINTENANCE FEE PAYMENT

Claimant Name: Clark H. Skyles/RENEWALS minimum

Address: PO Box 1169

City: Florence State: AZ Zip: 85232

Telephone: 602 722 0861

E-mail address: _____

Signature: Clark H. Skyles

Check here if this is a change of address.

RECEIVED
B.L.M. AZ STATE OFFICE
PHOENIX, ARIZONA
2005 AUG 24 P 12: 3

BLM
Date
Stamp

LINE NO.	AMC NUMBER	CLAIM/SITE NAME	COUNTY RECORDER DATA (If available)	TWP	RNG	SEC
1	356003	Blue Rock 20				
2	356004	21				
3	356005	22				
4	356059	23				
5	356060	24				
6	356061	25				
7	356062	26				
8	356063	27				
9	356064	28				
10	356065	29				

List additional claims on Form MCF114.

Bureau of Land Management
Arizona State Office
www.az.blm.gov

No. of Claims: 10 x \$125 = 1,250
Check No: 1176 Init. TMC
Receipt No.: 1136368
For BLM Use Only

Form: MCF112
Revised July 2005

This form is available from the Arizona Department of Mines and Mineral Resources and may be reproduced.

ENTERED IN COMPUTER
RE 8/31/06

MAINTENANCE FEE PAYMENT

Claimant Name: CHARK HEISLER
 Address: PO BOX 1169
 City: Florence State: AZ Zip: 85232
 Telephone: 602 722 0861
 E-mail address: _____
 Signature: Chark Heisler

Check here if this is a change of address.

RECEIVED
 B.L.M. AZ STATE OFFICE
 2005 AUG 24 P 12:13
 PHOENIX, ARIZONA
 BLM
 Date
 Stamp

LINE NO	AMC NUMBER	CLAIM/SITE NAME	COUNTY RECORDER DATA (If available)	TWP	RNG	SEC
1	336106	BLUE ROCK 1		33	4S	R11E
2	336107	2				
3	336108	3				
4	336109	4				
5	336110	5				
6	336114	9				
7	336116	11				
8	336121	16				
9						
10						

List additional claims on Form MCF114.

Bureau of Land Management
 Arizona State Office
www.az.blm.gov

No. of Claims: 8 x \$125 = 1,000
 Check No: 1176 Init. JMC
 Receipt No.: 1136368
 For BLM Use Only

Form: MCF112
 Revised July 2005

This form is available from the Arizona Department of Mines and Mineral Resources and may be reproduced.

ENTERED IN COMPUTER

RE 8/31/06

United States Department of the Interior
Bureau of Land Management
 BUSINESS & SUPPORT SVCS DIV
 222 N CENTRAL AVE
 PHOENIX, AZ 85004 -2203
 Phone: (602) 417-9200

Receipt	
No:	1136368

Transaction #: 1175506
Date of Transaction: 08/24/2005
CUSTOMER: RED HILLS MINING LLC P. O. BOX 1169 FLORENCE, AZ 85232

LINE #	QTY	DESCRIPTION	REMARKS	UNIT PRICE	TOTAL
1	1.00	LOCATABLE MINERALS / MINING CLAIMS-NOT NEW-UNADJUD, ONE AUTH NO. ONLY / MINING CLAIM MONEY RECEIVED (455) CASES: AMC356123/\$5375.00	MAINT 2006/43	- n/a -	5375.00
TOTAL:					\$5,375.00

PAYMENT INFORMATION			
1	AMOUNT:	\$5,375.00	POSTMARKED: N/A
	TYPE:	CHECK	RECEIVED: 08/24/2005
	CHECK NO:	1176	
	NAME:	RED HILLS MINING LLC P. O. BOX 1169 FLORENCE AZ 85232	

REMARKS

This receipt was generated by the automated BLM Collections and Billing System and is a paper representation of a portion of the official electronic record contained therein.

AMC 336106
 AMC 356123
 AMC 356059
 AMC 356003

Sc

MAINTENANCE FEE PAYMENT

BUREAU OF LAND MANAGEMENT
 222 N CENTRAL AVENUE
 PHOENIX, AZ 85004
 602-417-9200
 www.az.blm.gov

Mining Claim Maintenance Fee Payment of \$125 per claim/site is due on or before September 1, 20____, in lieu of assessment work for the upcoming assessment year beginning September 1 of the year noted above.

RECEIVED
 B.L.M. AZ STATE OFFICE
 2004 AUG 30 P 2:38
 PHOENIX, ARIZONA
 BLM Date Stamp

AMC NUMBER	CLAIM/SITE NAME	COUNTY RECORDER DATA	SEC	TWP	RNG
356003	Blue Rock 20				
356004	Blue Rock 21				
356005	Blue Rock 22				
356059	Blue Rock 23				
356060	Blue Rock 24				
356061	Blue Rock 25				
356062	Blue Rock 26				
356063	Blue Rock 27				
356064	Blue Rock 28				
356065	Blue Rock 29				

List additional claims on the reverse side of this form.

Check here if this is a change of address.

CLAIMANT NAME: Clark Hestley / Red Hills Mining LLC
 ADDRESS: PO BOX 1169
 CITY: Florence STATE: AZ ZIP: 85232
 PHONE: 602 722 0861
 SIGNATURE: Clark Hestley

No of Claims: 10 x \$125 = 1250.00
and 25 x \$125 = 3125.00
 Check No: 984 Init: EG
 Receipt No: _____
 FOR BLM USE ONLY

Claimant or agent must sign to record with the County.

FORM APPROVED OMB NO. 1004-0114
 Expires: December 31, 2006

AZ-3850-2
 (July 2004)

ENTERED IN COMPUTER
852 9/24/04 Wm 10/21/04 Sc

AMC NUMBER	CLAIM/SITE NAME	COUNTY RECORDER DATA	SEC	TWP	RNG

43 CFR 3833.0-5(e) (August 30, 1994) requires that the names and current addresses of all owners shall be identified on all instruments to be recorded or filed.

Name: _____ Address: _____

City: _____ State: _____ Zip: _____ *Change of address*

Name: _____ Address: _____

City: _____ State: _____ Zip: _____ *Change of address*

Name: _____ Address: _____

City: _____ State: _____ Zip: _____ *Change of address*

Name: _____ Address: _____

City: _____ State: _____ Zip: _____ *Change of address*

Name: _____ Address: _____

City: _____ State: _____ Zip: _____ *Change of address*

PRIVACY ACT STATEMENT – This information is being collected pursuant to 30 U.S.C. 28, 43 CFR 3833.2, and ARS 27-208 in compliance with the laws of the USDI, Bureau of Land Management, and the State of Arizona. The purpose of this collection is to facilitate processing of claims or applications. This form is covered by Privacy Act Notice #INTERIOR/LLM -32 and is subject to the routine uses stated in that notice. Privacy Act Notice #INTERIOR/LLM-32 is available at the BLM Arizona State Office. This form may be locally reproduced.

**CONTINUATION SHEET
MAINTENANCE FEE PAYMENT**

AMC NUMBER	CLAIM/SITE NAME	COUNTY RECORDER DATA	SEC	TWP	RNG
356066	BLUEROCK 30				
356067	BLUEROCK 31				
356068	BLUEROCK 32				
356069	BLUEROCK 33				
356070	BLUEROCK 34				
356071	BLUEROCK 35				
356072	BLUEROCK 36				
356073	BLUEROCK 37				
356074	BLUEROCK 38				
356075	BLUEROCK 39				
356123	BLUEROCK 40				
356124	BLUEROCK 41				
356125	BLUEROCK 42				
356126	BLUEROCK 43				
356127	BLUEROCK 44				
356128	BLUEROCK 45				
356129	BLUEROCK 46				
356130	BLUEROCK 47				

Date Entered Into Computer: 9/24/04
 Initials: RWE Verified: _____

ENTERED IN COMPUTER

RE 9/24/04

RECEIVED
 B.L.M. AZ STATE OFFICE
 2004 AUG 30 P 2:38
 PHOENIX, ARIZONA
 BLM DATE STAMP

**CONTINUATION SHEET
MAINTENANCE FEE PAYMENT**

AMC NUMBER	CLAIM/SITE NAME	COUNTY RECORDER DATA	SEC	TWP	RNG
356131	Blue rock 48				
356132	Blue rock 49				
356133	Blue rock 50				
356134	Blue rock 51				
356135	Blue rock 52				
356136	Blue rock 53				
356137	Blue rock 54				

Date Entered Into Computer: 9/24/09
 Initials: RWE Verified: _____

RECEIVED
 BLM, AZ STATE OFFICE
 2009 AUG 30 P 2:38
 PHOENIX, ARIZONA
 BLM DATE STAMP

MAINTENANCE FEE PAYMENT

BUREAU OF LAND MANAGEMENT
 222 N CENTRAL AVENUE
 PHOENIX, AZ 85004
 602-417-9200
 www.az.blm.gov

Mining Claim Maintenance Fee Payment of \$125 per claim/site is due on or before September 1, 20____, in lieu of assessment work for the upcoming assessment year beginning September 1 of the year noted above.

RECEIVED
 B.L.M. AZ STATE OFFICE
 2004 AUG 30 P 2:37
 PHOENIX, ARIZONA
 BLM Date Stamp

AMC NUMBER	CLAIM/SITE NAME	COUNTY RECORDER DATA	SEC	TWP	RNG
336106	BLUEROCK 1		33	4S	R11E
336107	BLUEROCK 2		33	4S	R11E
336108	BLUEROCK 3		33	4S	R11E
336109	BLUEROCK 4		33	4S	R11E
336110	BLUEROCK 5		33	4S	R11E
336114	BLUEROCK 9		33	4S	R11E
336116	BLUEROCK 11		33	4S	R11E
336121	BLUEROCK 16		33	4S	R11E

List additional claims on the reverse side of this form.

Check here if this is a change of address.

CLAIMANT NAME: CLARK HENSLER / REDHILLS MINING
 ADDRESS: PO BOX 1169
 CITY: FLORENCE STATE: AZ ZIP: 85232
 PHONE: 6027220861
 SIGNATURE: Clark Hensler

No of Claims: 8 x \$125 = 1000.00
 Check No: _____ Init: _____
 Receipt No: _____
FOR BLM USE ONLY

Claimant or agent must sign to record with the County.
 ENTERED IN COMPUTER
 8c a 12414

AMC NUMBER	CLAIM/SITE NAME	COUNTY RECORDER DATA	SEC	TWP	RNG

43 CFR 3833.0-5(e) (August 30, 1994) requires that the names and current addresses of all owners shall be identified on all instruments to be recorded or filed.

Name: _____ Address: _____

City: _____ State: _____ Zip: _____ *Change of address*

Name: _____ Address: _____

City: _____ State: _____ Zip: _____ *Change of address*

Name: _____ Address: _____

City: _____ State: _____ Zip: _____ *Change of address*

Name: _____ Address: _____

City: _____ State: _____ Zip: _____ *Change of address*

Name: _____ Address: _____

City: _____ State: _____ Zip: _____ *Change of address*

PRIVACY ACT STATEMENT – This information is being collected pursuant to 30 U.S.C. 28, 43 CFR 3833.2, and ARS 27-208 in compliance with the laws of the USDI, Bureau of Land Management, and the State of Arizona. The purpose of this collection is to facilitate processing of claims or applications. This form is covered by Privacy Act Notice #INTERIOR/LLM -32 and is subject to the routine uses stated in that notice. Privacy Act Notice #INTERIOR/LLM-32 is available at the BLM Arizona State Office. This form may be locally reproduced.

United States Department of the Interior
Bureau of Land Management
 BUSINESS & SUPPORT SVCS DIV
 222 N CENTRAL AVE
 PHOENIX, AZ 85004 -2203
 Phone: (602) 417-9200

Receipt	
No:	941588

Transaction #: 975958
Date of Transaction: 08/30/2004
CUSTOMER: RED HILLS MINING LLC P. O. BOX 1169 FLORENCE, AZ 85232

LINE #	QTY	DESCRIPTION	REMARKS	UNIT PRICE	TOTAL
1	1.00	LOCATABLE MINERALS / MINING CLAIMS-NOT NEW-UNADJUD, ONE AUTH NO. ONLY / MINING CLAIM MONEY RECEIVED (455) CASES: AMC356003/\$5375.00	MAINT 2005 (43)	- n/a -	5375.00
TOTAL:					\$5,375.00

PAYMENT INFORMATION			
1	AMOUNT:	\$5,375.00	POSTMARKED: N/A
	TYPE:	CHECK	RECEIVED: 08/30/2004
	CHECK NO:	984	
	NAME:	RED HILLS MINING LLC P. O. BOX 1169 FLORENCE AZ 85232	

REMARKS

This receipt was generated by the automated BLM Collections and Billing System and is a paper representation of a portion of the official electronic record contained therein.

AMC 356003
AMC 356059
AMC 356123

MAINTENANCE FEE PAYMENT

Mining Claim Maintenance Fee Payment of \$100 per claim or site is due on or before September 1, 2003, in lieu of assessment work for the upcoming assessment year beginning September 1 of the year noted above.

BUREAU OF LAND MANAGEMENT
ARIZONA STATE OFFICE
222 NORTH CENTRAL AVENUE
PHOENIX, AZ 85004
602-417-9200
www.az.blm.gov

FOR BLM USE ONLY	
NO. OF CLAIMS: <u>35</u>	X \$100 = \$ <u>3,500⁰⁰</u>
RECEIPT NO.: _____	CHECK NO.: <u>1083</u>
INIT: <u>TR</u>	

BLM SERIAL
NUMBERS

NAME OF CLAIMS/SITES

3	1. AMC <u>356003-356005</u>	<u>Blue rock 20-22</u>
17	2. AMC <u>356059-356075</u>	<u>Blue rock 23-39</u>
15	3. AMC <u>356123-356137</u>	<u>Blue rock 40-54</u>
	4. AMC _____	_____
	5. AMC _____	_____
	6. AMC _____	_____
	7. AMC _____	_____
	8. AMC _____	_____
	9. AMC _____	_____
	10. AMC _____	_____

List additional claims on the reverse side of this form.

CHECK HERE IF THIS IS A CHANGE OF ADDRESS

CLAIMANT'S NAME: Red Hills Mining LLC
Ejo Martin McKenna
ADDRESS: 4101 E. Tamaya St
CITY: Phoenix STATE: AZ ZIP: 85044
PHONE: 602-291-9779

Signature: [Signature]
To record with the County, one claimant or an agent must sign.

RECEIVED
B.L.M. AZ STATE OFFICE
2003 AUG 13 P 2:02
PHOENIX, ARIZONA

BLM DATE STAMP

ENTERED INTO COMPUTER
8/21/03
TES.

✓
[Signature]

NAME: Clark Heister ADDRESS: P.O. Box 1169
CITY: Florence STATE: AZ ZIP: 85232 IS THIS A NEW ADDRESS

NAME: Larry Farnsworth ADDRESS: 6502 E. Heather Lane
CITY: Mesa STATE: AZ ZIP: 85212 IS THIS A NEW ADDRESS

NAME: _____ ADDRESS: _____
CITY: _____ STATE: _____ ZIP: _____ IS THIS A NEW ADDRESS

NAME: _____ ADDRESS: _____
CITY: _____ STATE: _____ ZIP: _____ IS THIS A NEW ADDRESS

NAME: _____ ADDRESS: _____
CITY: _____ STATE: _____ ZIP: _____ IS THIS A NEW ADDRESS

NAME: _____ ADDRESS: _____
CITY: _____ STATE: _____ ZIP: _____ IS THIS A NEW ADDRESS

NAME: _____ ADDRESS: _____
CITY: _____ STATE: _____ ZIP: _____ IS THIS A NEW ADDRESS

NAME: _____ ADDRESS: _____
CITY: _____ STATE: _____ ZIP: _____ IS THIS A NEW ADDRESS

FOR BLM USE ONLY	
DATE ENTERED INTO COMPUTER:	_____
INITIALS:	_____ VERIFIED: _____

**United States Department of the Interior
Bureau of Land Management**

BUSINESS & SUPPORT SVCS DIV
222 N CENTRAL AVE
PHOENIX, AZ 85004 -2203
Phone: (602) 417-9200

Receipt

No: 729303

Transaction #: 758685
Date of Transaction: 08/13/2003

CUSTOMER: MARTIN J MCKENNA
RED HILLS MINING, LLC
4101 E. TAMAYA STREET
PHOENIX, AZ 85044

LINE #	QTY	DESCRIPTION	REMARKS	UNIT PRICE	TOTAL
1	1.00	LOCATABLE MINERALS / MINING CLAIMS-NOT NEW-UNADJUD, ONE AUTH NO. ONLY / MINING CLAIM MONEY RECEIVED (455) CASES: AMC356003/\$3500.00	MAINT 2004 (35)	- n/a -	3500.00
TOTAL:					\$3,500.00

PAYMENT INFORMATION

1	AMOUNT: \$3,500.00	POSTMARKED: N/A
	TYPE: CHECK	RECEIVED: 08/13/2003
	CHECK NO: 1083	
	NAME: RED HILLS MINING, LLC MCKENNA, MARTIN J 4101 E. TAMAYA STREET PHOENIX AZ 85044	

REMARKS

This receipt was generated by the automated BLM Collections and Billing System and is a paper representation of a portion of the official electronic record contained therein.

MAINTENANCE FEE PAYMENT

Mining Claim Maintenance Fee Payment of \$100 per claim or site is due on or before September 1, 2002, in lieu of assessment work for the upcoming assessment year beginning September 1 of the year noted above.

BUREAU OF LAND MANAGEMENT
ARIZONA STATE OFFICE
222 NORTH CENTRAL AVENUE
PHOENIX, AZ 85004
602-417-9200
www.az.blm.gov

FOR BLM USE ONLY	
NO. OF CLAIMS: <u>35</u>	X \$100 = \$ <u>3,500</u>
RECEIPT NO.: <u>3551679</u>	CHECK NO.: <u>1069</u>
INIT: <u>TR</u>	

BLM SERIAL
NUMBERS

NAME OF CLAIMS/SITES

- | | |
|-----------------------------|------------------------|
| 1. AMC <u>356003-356005</u> | <u>Blue rock 20-22</u> |
| 2. AMC <u>356059-356075</u> | <u>Blue rock 23-39</u> |
| 3. AMC <u>356123-356137</u> | <u>Blue rock 40-54</u> |
| 4. AMC _____ | _____ |
| 5. AMC _____ | _____ |
| 6. AMC _____ | _____ |
| 7. AMC _____ | _____ |
| 8. AMC _____ | _____ |
| 9. AMC _____ | _____ |
| 10. AMC _____ | _____ |

List additional claims on the reverse side of this form.

CHECK HERE IF THIS IS A CHANGE OF ADDRESS

CLAIMANT'S NAME: Red Hills Mining LLC
% Martin McKenna
ADDRESS: 4101 E. Tama Ya St.
CITY: Phoenix STATE: AZ ZIP: 85044
PHONE: 602-291-9479

Signature: Martin McKenna
To record with the County, one claimant or an agent must sign.

RECEIVED B.L.M. AZ STATE OFFICE	2002 AUG 29 A 11:18
	PHOENIX, ARIZONA
BLM DATE STAMP	

ENTERED IN COMPUTER
RS 9/19/2002 10/A3109TK
VERIFIED

MAINTENANCE FEE PAYMENT

Mining Claim Maintenance Fee Payment of \$100 per claim or site is due on or before September 1, 2002, in lieu of assessment work for the upcoming assessment year beginning September 1 of the year noted above.

BUREAU OF LAND MANAGEMENT
ARIZONA STATE OFFICE
222 NORTH CENTRAL AVENUE
PHOENIX, AZ 85004
602-417-9200
www.az.blm.gov

FOR BLM USE ONLY	
NO. OF CLAIMS: <u>8</u>	X \$100 = \$ <u>800</u>
RECEIPT NO.: <u>551679</u>	CHECK NO.: <u>1068, 2009</u>
INIT: <u>TR</u>	

BLM SERIAL
NUMBERS

NAME OF CLAIMS/SITES

- | | |
|-----------------------------|---------------------|
| 1. AMC <u>336106-336110</u> | <u>Bluerock 1-5</u> |
| 2. AMC <u>336114</u> | <u>Bluerock #9</u> |
| 3. AMC <u>336116</u> | <u>Bluerock #11</u> |
| 4. AMC <u>336121</u> | <u>Bluerock #16</u> |
| 5. AMC _____ | _____ |
| 6. AMC _____ | _____ |
| 7. AMC _____ | _____ |
| 8. AMC _____ | _____ |
| 9. AMC _____ | _____ |
| 10. AMC _____ | _____ |

List additional claims on the reverse side of this form.

CHECK HERE IF THIS IS A CHANGE OF ADDRESS

CLAIMANT'S NAME: Martin J. McKenna
 ADDRESS: 4101 E. Tamaya ST.
 CITY: Phoenix STATE: AZ ZIP: 85044
 PHONE: 602-291-9749

Signature: [Signature]
 To record with the County, one claimant or an agent must sign.

RECEIVED B.L.M. AZ STATE OFFICE	2002 AUG 29 A 11:18
	PHOENIX, ARIZONA
BLM DATE STAMP	

ENTERED IN COMPUTER
RE 9/19/2002

United States Department of the Interior
Bureau of Land Management
 BUSINESS & SUPPORT SVCS DIV
 222 N CENTRAL AVE
 PHOENIX, AZ 85004 -2203
 Phone: (602) 417-9200

Receipt	
No:	551679

Transaction #: 576406
Date of Transaction: 08/29/2002
CUSTOMER: RED HILLS MIMING LLC 4101 E TAMAYA ST PHOENIX, AZ 85044

LINE #	QTY	DESCRIPTION	REMARKS	UNIT PRICE	TOTAL
1	1.00	LOCATABLE MINERALS / MINING CLAIMS-NOT NEW-UNADJUD, ONE AUTH NO. ONLY / MINING CLAIM MONEY RECEIVED (455) CASES: AMC336106/\$4300.00	MAINT 2003 (43)	- n/a -	4300.00
TOTAL:					\$4,300.00

PAYMENT INFORMATION			
1	AMOUNT:	\$3,500.00	POSTMARKED: N/A
	TYPE:	CHECK	RECEIVED: 08/29/2002
	CHECK NO:	1069	
	NAME:	RED HILLS MIMING LLC 4101 E TAMAYA ST PHOENIX AZ 85044	
2	AMOUNT:	\$800.00	POSTMARKED: N/A
	TYPE:	CHECK	RECEIVED: 08/29/2002
	CHECK NO:	1068	
	NAME:	RED HILLS MIMING LLC 4101 E TAMAYA ST PHOENIX AZ 85044	

REMARKS

This receipt was generated by the automated BLM Collections and Billing System and is a paper representation of a portion of the official electronic record contained therein.

NOTICE!!

These documents have been scanned!

Do not place un-scanned documents beneath this notice!

Do not remove this notice from this file!

GPO Jacket No. 560-102
Print Order 61540
Rise Business Services, LLC
Job=AZ15 6/26/2019



Box Number= AZ15134



Claim Begin-End: AMC356003-AMC356005

5 Miscellaneous



AZ15134-1

AMC356454-AMC363464

**NO
DOCUMENTS
FOUND**

NO DOCUMENTS FOUND
NO DOCUMENTS FOUND

NOTICE!!

These documents have been scanned!

Do not place un-scanned documents beneath this notice!

Do not remove this notice from this file!

GPO Jacket No. 560-102
Print Order 61540
Rise Business Services, LLC
Job=AZ15 6/26/2019



Box Number= AZ15134



Claim Begin-End: AMC356003-AMC356005

6 Location Notices-Amendments and Supporting Documents



AZ15134-1 AMC356454-AMC363464

MINING CLAIM STATUS REPORT

Status Checked By:	<u>BR</u>
MTP Checked By:	<u>BR</u>
GEO Checked By:	<u>BR</u>
Preadjudication By:	
Final Adjudication By:	<u>BR 7/17/02</u>

LEAD SERIAL NO. AMC 356003 THROUGH AMC 356005

<u>3</u>	LODE	@ \$25 = \$	<u>75.00</u>	Location Fee
	PLACER	@ \$10 = \$	<u>30.00</u>	Service Fee--curable defect
	MILL SITE	@ \$100 = \$	<u>300.00</u>	Claim Maintenance Fee
	TUNNEL SITE	\$	<u>405.00</u>	TOTAL FEES
	ASSOCIATION	\$	<u>39</u>	Copy Fees
	PLACER	\$		Overage <input type="checkbox"/> Shortage <input type="checkbox"/>
		\$	<u>405.39</u>	TOTAL RECEIVED

OVER-THE-COUNTER: MAIL: Timely Filed: YES NO

LEGAL DESCRIPTION:

T <u>4S</u>	R <u>11E</u>	S <u>35,34</u>	T _____	R _____	S _____
T _____	R _____	S _____	T _____	R _____	S _____
T _____	R _____	S _____	T _____	R _____	S _____
T _____	R _____	S _____	T _____	R _____	S _____

GENERAL JURISDICTION: BLM or NATIONAL FOREST _____
Name

SPLIT ESTATE LAND: SX PX SRHE OTHER STATE LAND
Specify

WILDERNESS AREA (WA): _____
Specify

CLAIMS SUBJECT TO PL 359: YES NO

PROPER NOTICE FILED IF LOCATING ON SRHE: YES NO

COMMENTS: IS HUARD of the Special permits required by the state lands Dept. WMMAL

STATUS: PARTIALLY VOID VOID

PRIVATE MINERALS WITHDRAWN OTHER

COMMENTS: _____

8



OFFICIAL RECORDS OF PINAL COUNTY RECORDER

LAURA DEAN-LYTLE

STATE OF _____ } ss. I hereby certify that the within instrument
COUNTY OF _____ } filed for record in
B.U.M. AZ STATE OFFICE
State of _____

DATE: 11/23/01 TIME: 1636
FEE : 10.00
PAGES: 2
FEE NO: 2001-053798

Witness my hand and Official Seal.
Indexed Paged Blotted
2002 FEB 19 P 12:04
County Recorder
By _____ Deputy
PHOENIX, ARIZONA

When recorded, mail to: Martin J. McKenna 4101 E. Tamaya St., Phoenix, AZ 85044

NOTICE OF MINING CLAIM

- 1. TYPE OF NOTICE: Location Amendment Relocation
- 2. TYPE OF CLAIM: Placer Lode Millsite Tunnelsite
- 3. The name and address of the Locator is

Red Hills Mining LLC

NAME

4101 E. Tamaya St.

ADDRESS

Phoenix, AZ

CITY

85044

STATE

ZIP

- 4. The name of the claim is Bluerock 20
- 5. The date of the location is 23 November 2001
- 6. The claim is 1500 feet long and 600 feet wide. The distance from the Location monument to each end of the claim is 1490 feet in a west direction and 300 feet in a north direction.
- 7. The general course of the claim is from the east to the west.
- 8. The location of the claim is in Section _____, Township 4S, Range 11E, Gila and Salt River Base and Meridian, Phoenix Mining District, Pinal County, State of Arizona.
- 9. If amending or relocating, the previous claim name was Redbird Number 20 recorded in Docket(Book) 1754 page(s) 767.
Red Hills Mining District, Pinal County, State of Arizona.
- 10. The location of the claim with reference to a natural object or permanent monument is The SW corner of the claim is 1500 feet in an east direction from the survey marker marking the SE corner of Section 33, T4S R11E.

Date 23 November, 2001

(signature)
Martin J. McKenna

4101 E. Tamaya St.

Phoenix, AZ, 85044
(city/state/zip)

AMC 356003

MAP OF MINING CLAIM LOCATION

1. The name of the claim is Bluerock 20
2. The SW corner of the claim is 1500 feet in a East direction to a survey monument or permanent natural object described as The survey marker marking the SE corner of Section 33 T4S R11E
3. The type of location monument is stones and a wooden post
The type of corner and end monuments are stones and a wooden post
4. The bearing and distance between the corners of the claim are beginning at the SW corner of the claim, 1500 feet in a East direction to the SE corner, then 600 feet in a North direction to the NE corner, then 1500 feet in a West direction to the NW corner, then 600 feet in a South direction to the point of beginning.

MAP

One inch = One thousand feet

North Arrow



ONE MILE

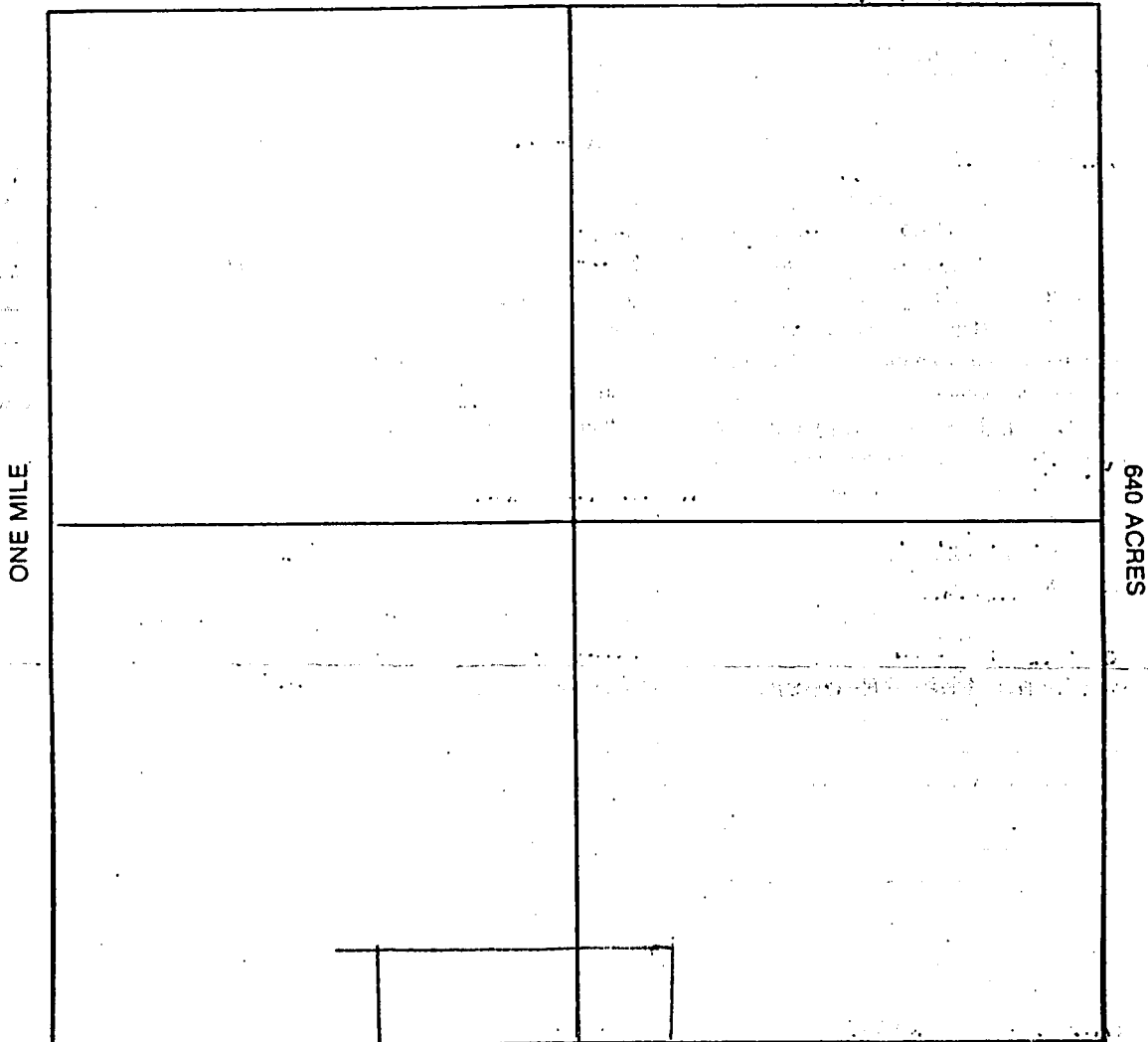

Section 34 Range 11E Township 4S
Gila and Salt River Base and Meridian.

Date 23 November 2001

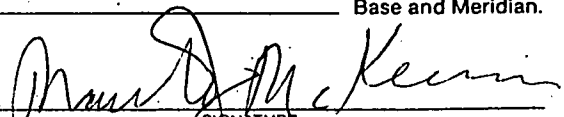
SIGNATURE

8

STATE OF _____ }
 COUNTY OF _____ } ss. I hereby certify that the within instrument
 filed for record in _____
 B.L. HARRIS STATE OFFICE
 2002 FEB 19 P 12:04
 County Recorder
 By _____ Deputy



OFFICIAL RECORDS OF
 PINAL COUNTY RECORDER
 LAURA DEAN-LYTLE

DATE: 11/23/01 TIME: 1636
 FEE: 10.00
 PAGES: 2
 FEE NO: 2001-053799

When recorded, mail to: Martin J. McKenna 4101 E. Tamaya St., Phoenix, AZ 85044

NOTICE OF MINING CLAIM

- 1. TYPE OF NOTICE: Location Amendment Relocation
- 2. TYPE OF CLAIM: Placer Lode Millsite Tunnelsite
- 3. The name and address of the Locator is

Red Hills Mining LLC

NAME

4101 E. Tamaya St.

ADDRESS

Phoenix, AZ

85044

CITY

STATE

ZIP

- 4. The name of the claim is Bluerock 21
- 5. The date of the location is 23 November 2001
- 6. The claim is 1500 feet long and 600 feet wide. The distance from the Location monument to each end of the claim is 1490 feet in a East direction and 300 feet in a north direction.
- 7. The general course of the claim is from the east to the west.
- 8. The location of the claim is in Section _____, Township 4S, Range 11E, Gila and Salt River Base and Meridian, Phoenix Mining District, Pinal County, State of Arizona.
- 9. If amending or relocating, the previous claim name was Redbird 21 recorded in Docket(Book) 1754 page(s) 769 of Red Hills Mining District, Pinal County, State of Arizona.
- 10. The location of the claim with reference to a natural object or permanent monument is The SW corner of the claim is feet in an _____ direction from the survey marker marking the SE corner of Section 33, T4S R11E.

Date 23 November, 2001

Martin J. McKenna
 (signature)

Martin J. McKenna

4101 E. Tamaya St.

Phoenix, AZ, 85044
 (city/state/zip)

AMC 356004

MAP OF MINING CLAIM LOCATION

1. The name of the claim is Bluerock 21
2. The SW corner of the claim is 3000 feet in a east direction to a survey monument or permanent natural object described as The survey marker marking the SE corner of Section 33 T4S R11E
3. The type of location monument is stones and a wooden post
The type of corner and end monuments are stones and a wooden post
4. The bearing and distance between the corners of the claim are beginning at the SW corner of the claim, 1500 feet in a East direction to the SE corner, then 600 feet in a North direction to the NE corner, then 1500 feet in a West direction to the NW corner, then 600 feet in a South direction to the point of beginning.

MAP

One inch = One thousand feet

North Arrow



ONE MILE

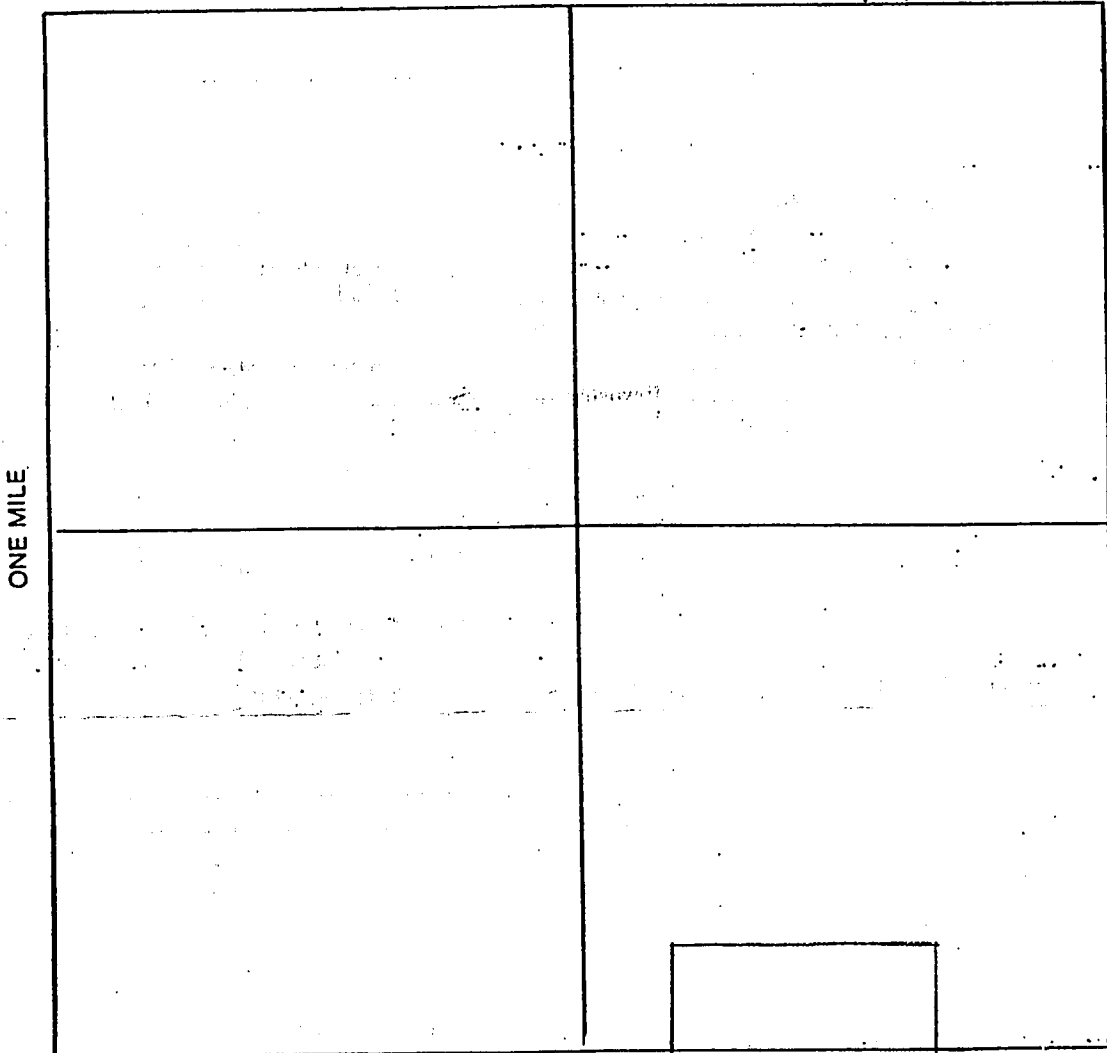

Section 34 Range 11E Township 4S
Gila and Salt River Base and Meridian.

Date 23 November 2001

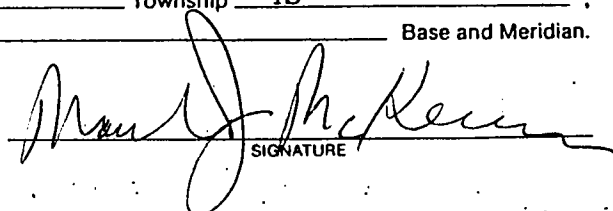
SIGNATURE



OFFICIAL RECORDS OF PINAL COUNTY RECORDER

LAURA DEAN-LYTTLE

DATE: 11/23/01 TIME: 1636

FEE: 10.00

PAGES: 2

FEE NO: 2001-053800

STATE OF ... COUNTY OF ... I hereby certify that the within instrument ... filed for record in ... State of ... RECEIVED ... STATE OFFICE ... County Recorder ... 2002 FEB 19 P 12:04 ... Deputy

When recorded, mail to: Martin J. McKenna 4101 E. Tamaya St., Phoenix, AZ 85044

NOTICE OF MINING CLAIM

- 1. TYPE OF NOTICE: Location Amendment Relocation
2. TYPE OF CLAIM: Placer Lode Millsite Tunnelsite
3. The name and address of the Locator is

Red Hills Mining LLC

NAME

4101 E. Tamaya St.

ADDRESS

Phoenix, AZ

85044

CITY

STATE

ZIP

- 4. The name of the claim is Bluerock 22
5. The date of the location is 23 November 2001
6. The claim is 1500 feet long and 600 feet wide. The distance from the Location monument to each end of the claim is 1490 feet in a East direction and 300 feet in a north direction.
7. The general course of the claim is from the east to the west.
8. The location of the claim is in Section 35, Township 4S, Range 11E, Gila and Salt River Base and Meridian, Phoenix Mining District, Pinal County, State of Arizona.
9. If amending or relocating, the previous claim name was Redbird 23 recorded in Docket(Book) 1754 page(s) 773 Red Hills Mining District, Pinal County, State of Arizona.
10. The location of the claim with reference to a natural object or permanent monument is The SW corner of the claim is 6000 feet in an east direction from the survey marker marking the SE corner of Section 33, T4S R11E.

Date 23 November, 2001

Signature of Martin J. McKenna

(signature)

Martin J. McKenna

4101 E. Tamaya St.

Phoenix, AZ, 85044

(city/state/zip)

ANC 356005

MAP OF MINING CLAIM LOCATION

1. The name of the claim is Bluerock 22
2. The SW corner of the claim is 6000 feet in a east direction to a survey monument or permanent natural object described as The survey marker marking the SE corner of Section 33 T4S R11E
3. The type of location monument is stones and a wooden post
The type of corner and end monuments are stones and a wooden post
4. The bearing and distance between the corners of the claim are beginning at the SW corner of the claim, 1500 feet in a East direction to the SE corner, then 600 feet in a North direction to the NE corner, then 1500 feet in a West direction to the NW corner, then 600 feet in a South direction to the point of beginning.

MAP

One inch = One thousand feet

North Arrow



ONE MILE

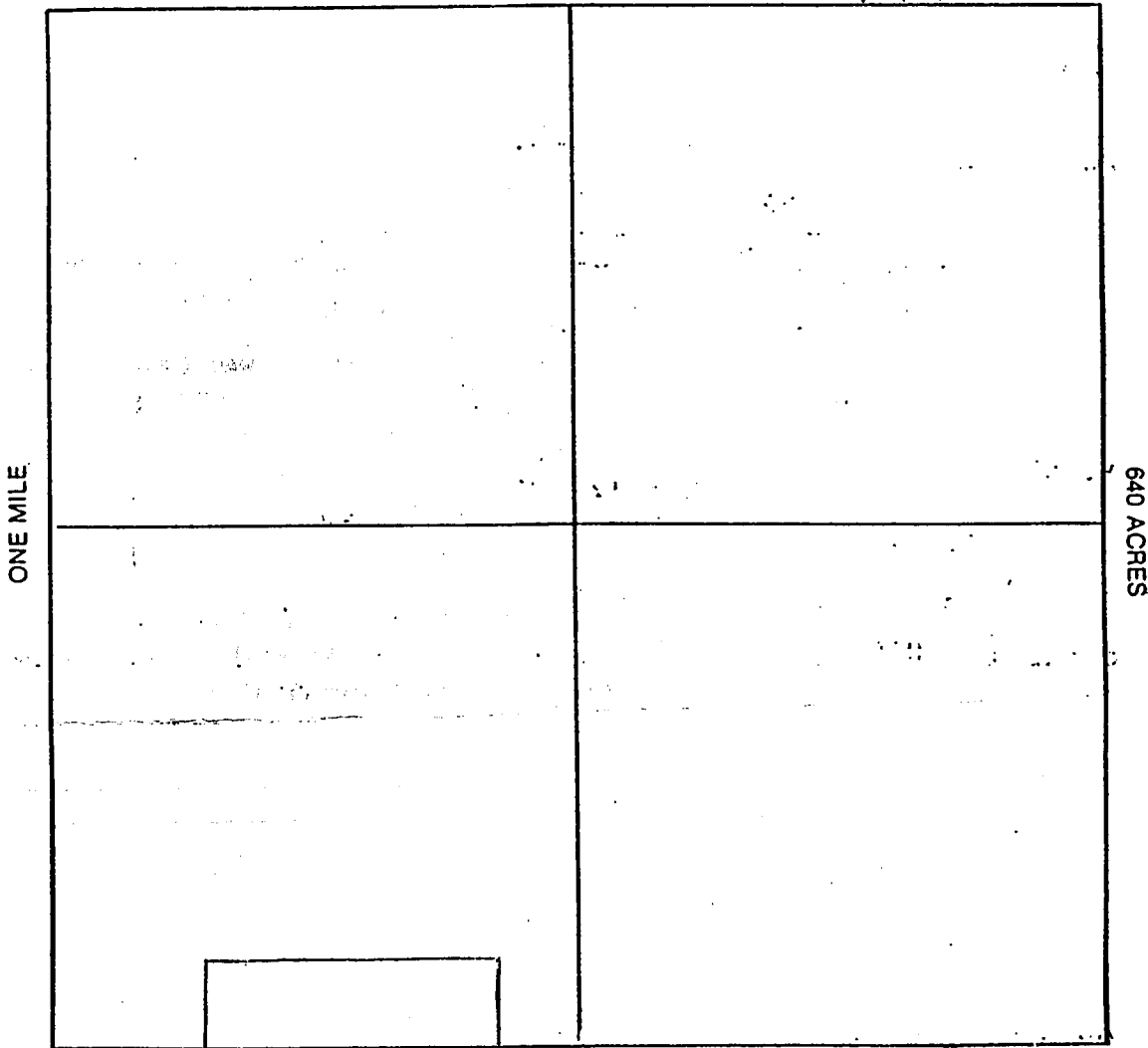

Section 35 Range 11E Township 4S
Gila and Salt River Base and Meridian.

Date 23 November 2001

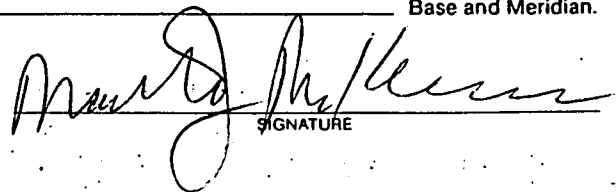
SIGNATURE

Input Parameters for Geographic Report with Land

System Id = CR

Admin State = AZ

Geo State = AZ

Casetype begins with

Case Disp Txt = AUTHORIZED, CANCELLED, CLOSED, EXPIRED, No Match, PENDING, REJECTED, RELINQUISHED, VOID, WITHDRAWN

Mer Twp Rng =

Mtrs = 14 0040S 0110E 034, 14 0040S 0110E 035

Commodity =

Pending Org =

Total Rows Returned: 3

RUN TIME: 11:53 AM

Adm State: AZ

UNITED STATES DEPARTMENT OF INTERIOR
BUREAU OF LAND MANAGEMENT
GEOGRAPHIC REPORT WITH LAND
Sorted by Serial Number

RUN DATE: 02/19/2002
Page 1 of 1

Serial Number: AZA 012335
Total Case Acres: 1,280.000

<u>Casetype</u>	<u>Case Disp</u>				<u>Sect</u>	<u>Sur Typ</u>	<u>Sur Num</u>	<u>Suff</u>	<u>Subdivision</u>	<u>Act Pend</u>
311111	CLOSED	14	0040S	0110E	034	ALIQ			ALL;	

Serial Number: AZA 018628
Total Case Acres: 4,400.000

<u>Casetype</u>	<u>Case Disp</u>				<u>Sect</u>	<u>Sur Typ</u>	<u>Sur Num</u>	<u>Suff</u>	<u>Subdivision</u>	<u>Act Pend</u>
311111	CLOSED	14	0040S	0110E	035	ALIQ			ALL;	

Serial Number: AZA 020990
Total Case Acres: 4,970.290

<u>Casetype</u>	<u>Case Disp</u>				<u>Sect</u>	<u>Sur Typ</u>	<u>Sur Num</u>	<u>Suff</u>	<u>Subdivision</u>	<u>Act Pend</u>
311211	CLOSED	14	0040S	0110E	034	FF		1	ALL;	

TOWNSHIP 4 SOUTH RANGE 11 EAST OF THE GILA AND SALT RIVER MERIDIAN, ARIZONA

PIVAL COUNTY

STATUS OF PUBLIC DOMAIN LAND AND MINERAL TITLES

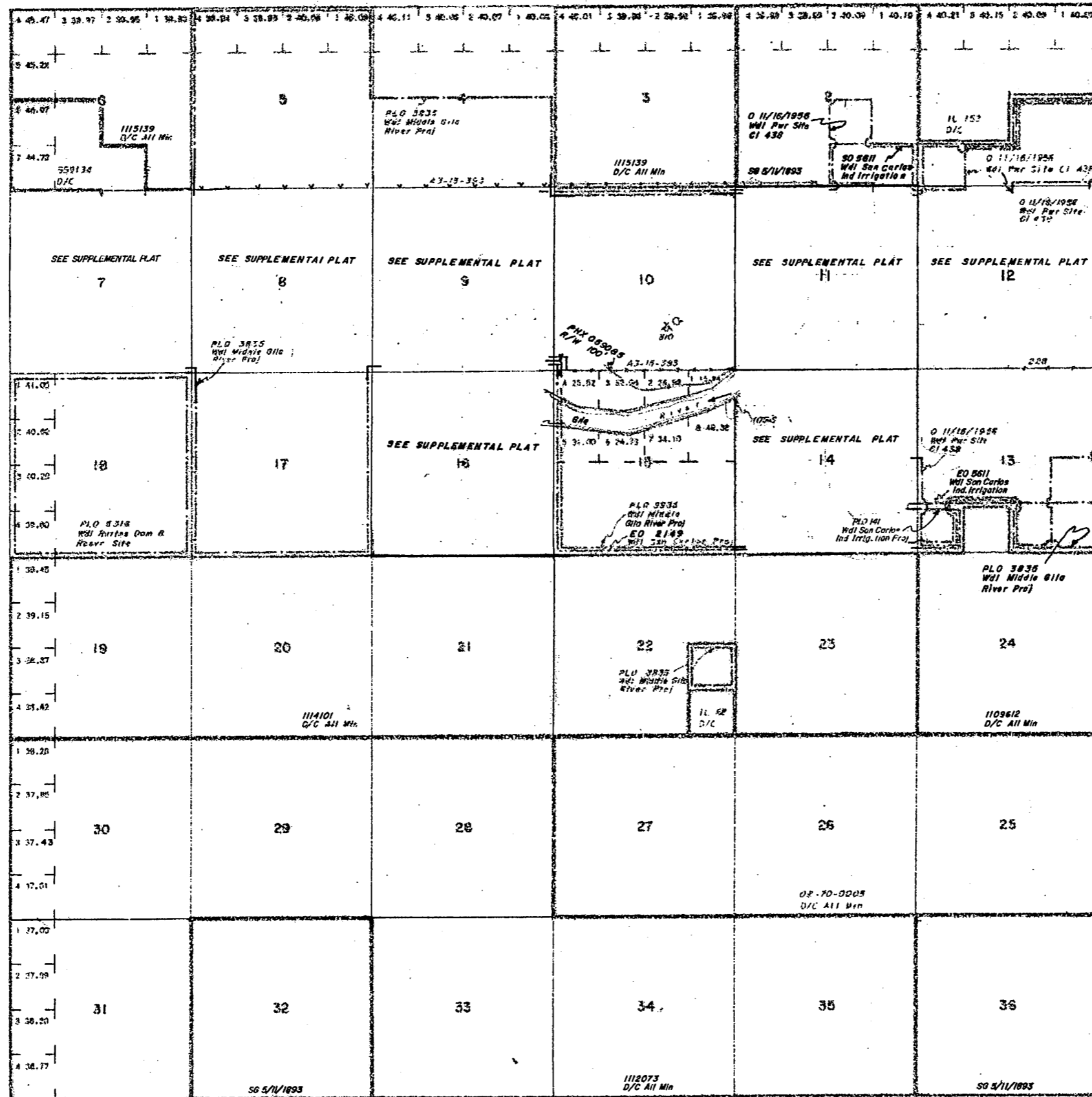

INDEX TO SEGMENTED TRACTS				
SEGMENT	ORIGINAL SURVEY			
	TRACT NO.	T	R	SUBSECTION

FOR OWNERS RESPECTING DISPOSAL OR USE OF UNDEVELOPED LANDS WITHDRAWN FOR CLARIFICATION OF MINERAL WATER AND/OR OTHER PUBLIC PURPOSES REFER TO INDEX OF MISCELLANEOUS DOCUMENTS.

DIST. NO. 2

A43790 1-13-1971 Opening to Me. E 1/2 Sec 17, Sub 1 to Final Sale.

A6122 Recd. State

Sec 17

Blank lined area for additional notes or signatures.

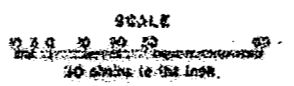

WARNING STATEMENT
This plat is the Bureau's version of Title, and should be used only as a guide to the location of the land. The Bureau does not warrant the accuracy of the information shown hereon and is not responsible for any errors or omissions. The Bureau is not responsible for any errors or omissions in the original survey or for any errors or omissions in the information shown hereon.

CURRENT TO	BY

T-02
P. 11